

**We cannot take any responsibility  
for any damage caused by not using  
our genuine filter or part.**

# HOT & COLD WATER PURIFIER OPERATION MANUAL

WHP-1670/WHP-1670S  
WHP-1670\_RO/WHP-1670S\_RO  
WHP-1680/WHP-1680S  
WHP-1680\_RO/WHP-1680S\_RO

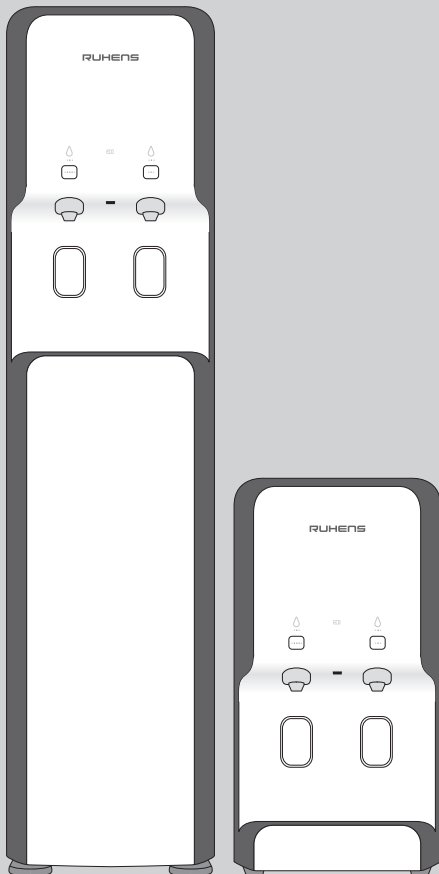

## For your safety

- Precautions ..... 2~6

## For information

- Features ..... 7
- Name of each part ..... 8~9
- Interior ..... 10~11
- UV LED SYSTEM (WHP-1680(S)/WHP-1680RO(S) ONLY) ··· 12
- Eco system ..... 13
- How to use hot & cold water purifier ..... 14~15
- Filter replacement method & cycle ..... 16~17
- Solutions to common problems ..... 18~19
- Cleaning method & cycle ..... 20
- Product specification & Filtration system ..... 21
- Warranty ..... 22

Please, read this manual for your safety and proper use.  
Keep this manual carefully. It has the product warranty.

# PRECAUTIONS

- Read carefully following precautions to prevent unpredictable dangers and damage.
- Depending on degree of dangers and damage that could occur by improper use, precautions are divided into 3 types as below.

 **Danger** : If not observed, serious injury or even death could occur.

 **Warning** : If not observed, serious injury or property damage could occur.

 **Caution** : If not observed, slight injury or property damage could occur.

 This mark is for calling attention to dangers caused by improper use. Carefully read and follow precautions.

 Water purifier should be maintained by periodic check. We can not take responsibility for any damage by improper maintenance by any individuals or third parties, not by us.

## Precautions for power supply



**Danger** This product must be plugged into AC 220-240V outlet.

- It could cause fire or electric shock.

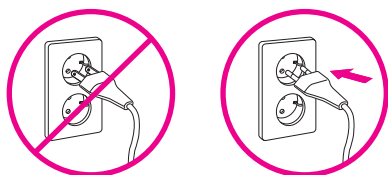

**Danger** Before use, wipe dust or other foreign substance off on the plug.

- It could cause fire or electric shock.



**Danger** Do not use when the plug is damaged or swinging.

- It could cause fire or electric shock & leakage.
- When the plug is damaged, contact customer service center or your purchasing place.

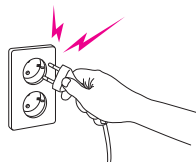

**Danger** Before replacing filter, unplug the power cord.

- It could cause electric shock.

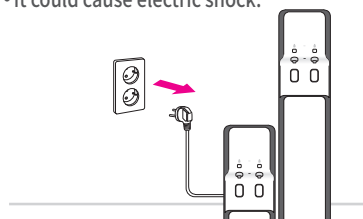

# PRECAUTIONS

## ⚠️ Precautions for power supply



Do not try to bend, tie or pull the power cord.

- It could cause fire by electric shock.

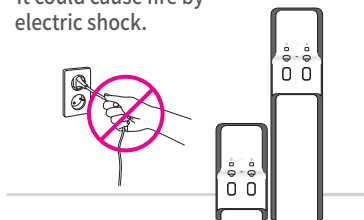

The outlet should be rated for more than 10A. Use a separate outlet for the unit.

- Do not overload the outlet with too many plugs. It can cause fire.

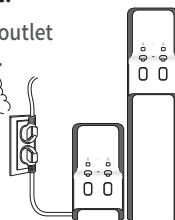

Do not disassemble or modify the plug.

- It could cause fire or electric shock.

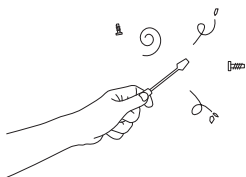

Do not plug in or unplug the power cord with wet hands.

- It could cause electric shock.

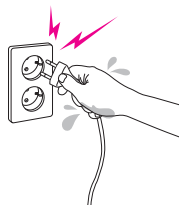

## ⚠️ Precautions for installation



Do not install the unit at a moist place like bathhouse, shower room or outdoor.

- It can cause fire or electric shock.

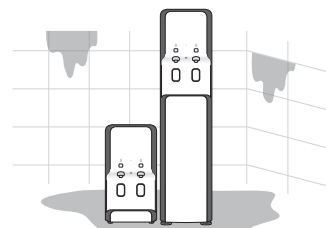

Do not let the inlet hose be twisted or bended.

- It could cause water and electric leakage.

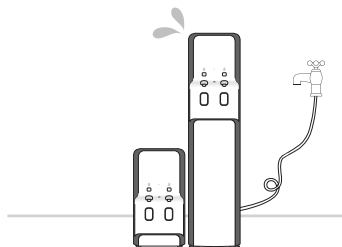

# PRECAUTIONS

## ⚠️ Precautions for installation



**Avoid heat and direct sunlight.**  
• It could cause deformation of the exterior.

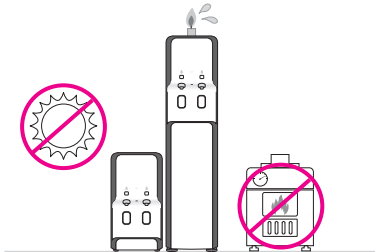

**Place the unit on a level and hard floor.**  
• It could cause malfunction.

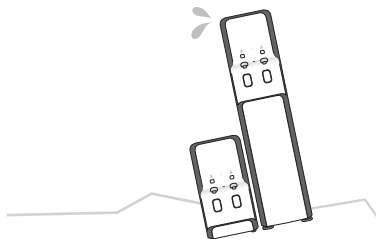

**Connect the unit only to the cold water pipe.**  
• It is harmful for filters to connect to hot water.

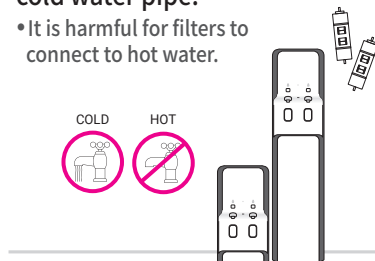

**Maintain a sufficient distance from the wall.**  
At least 8 inches is recommended.  
• It could cause malfunction.

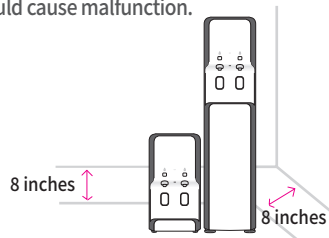

## ⚠️ Precautions for use



**Do not apply force to the unit.**  
• It could cause malfunction, damage or electric shock.

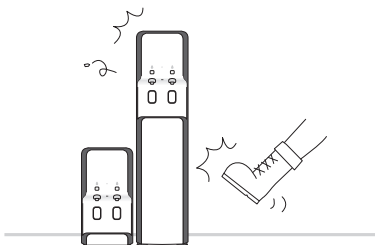

**Do not attempt to repair, disassemble, or transform.**  
• It could cause fire or electric shock.

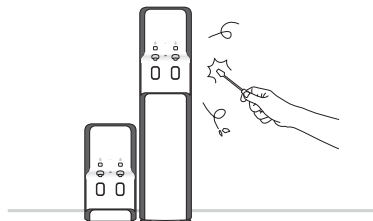

# PRECAUTIONS

## ⚠️ Precautions for use



**Danger**

**Do not insert sharp wire or screwdriver into the unit.**

- It could cause malfunction or electric shock.

**SAFETY FIRST**

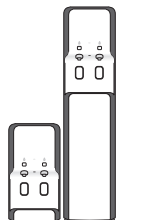

**Warning**

**Be careful not to get burned by the hot water.**

- It could cause scald.

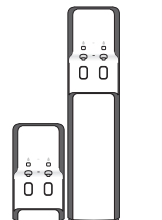

**Caution**

**Do not tilt the unit more than 45° while moving it.**

- It could cause malfunction.

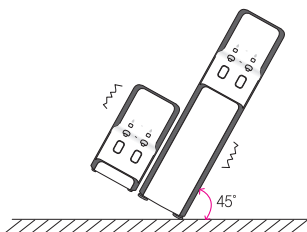

**Caution**

**Do not move the unit while it is being operated.**

- It could cause malfunction.

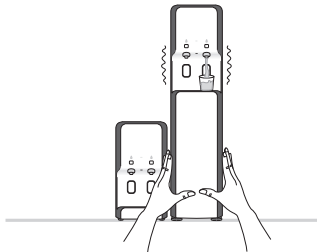

**Caution**

**Do not put heavy stuff on the unit.**

- It could cause damage to the unit.

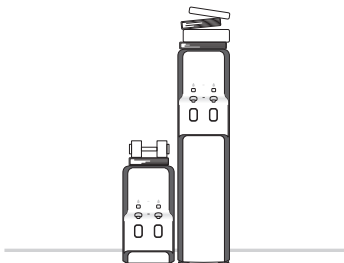

**Caution**

**When water supply is cut off, unplug the power cord.**

- It could cause malfunction.

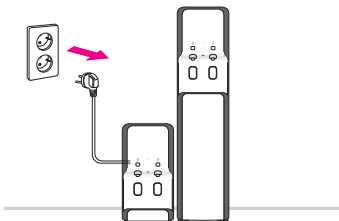

# PRECAUTIONS

## ⚠️ Precautions for use



Never use Benzene or gasoline to clean the unit.

- It could cause discolor, peeling and damage of the unit.

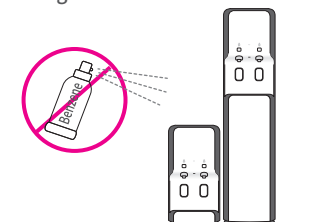

Close main water supply valve and unplug the power cord when not using the unit for a long time. Before use it again, drain more than 10 liters of water in water tank.

- It could cause fire or water leakage.

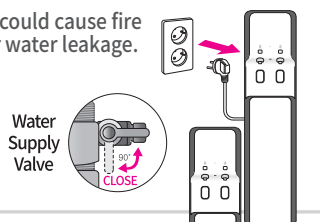

Before use, entirely close the cold tank cover in the unit.

- Insects or foreign substances may get inside of the product.

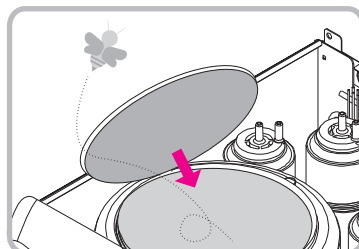

- When you discard the unit or filter, follow the proper process of disposal.
  - It could cause environmental pollution.

- When installing the unit, use our genuine parts.
  - It could cause water leakage or damage to the unit.

- When replacing filter, use our genuine one.
  - It could affect water quality.

- Do not install the unit at the place where may cause freezing trouble.

# FEATURES

## ★ Self sterilization by UV LED

Self UV LED sterilization system for ensuring the cleanness of the cold tank.

## ★ Power saving at night by ECO(illuminance sensor) function

The ECO sensor automatically stops water heating & chilling and save electric charge, when it notices that illuminance around the unit darkens at night.

## ★ Continuous water dispensing function

By this function, you can conveniently receive a large amount of water at once.

## ★ UF or RO membrane filter system

Our 4 steps of water filtration system provides fresh&clean water.

## ★ Electronic touch button

You can set all the functions(pasteurization, hot water safety, continuous cold water dispensing function) by electronic touch button.

## ★ Separable hidden water tap

Easily separable water taps help to keep hot & cold water taps always clean.

## ★ Thorough filtration system

### – WHP-1670(S), WHP-1680(S)

Sediment filter(removes contaminants) → Pre-carbon filter(removes residual chlorine) → UF membrane filter(removes bacteria and harmful organic chemicals) → Post carbon filter(removes residual toxic gas composition and odor)

### – WHP-1670(S)\_RO, WHP-1680(S)\_RO

Sediment filter(removes contaminants) → Pre-carbon filter(removes residual chlorine) → RO membrane filter(removes bacteria and harmful organic chemicals) → Post carbon filter(removes residual toxic gas composition and odor)

## ★ Safety in using hot water

Anti-Superheating function of heater(by manual reset type of bi-metal) & automatic temperature control function(by automatic reset type of bi-metal) keep you safe from hot water.

## ★ Water level control function

Automatic water level control function ensures durability of the filters & unit.

## ★ Fresh water supply

4~12°C of cold water and 70~90°C of hot water are available at any time.

## ★ Power saving function

When using only one sort of water temperature between hot & cold, you can turn the other temperature switch off and save electric charge.



# NAME OF EACH PART

Model No / WHP-1670S, WHP-1670S\_RO

Hot&Cold function

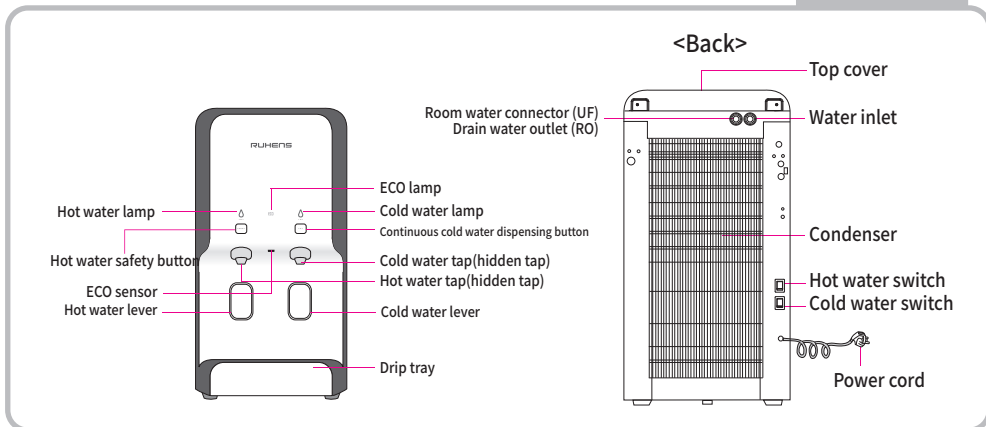

Model No / WHP-1670, WHP-1670\_RO

Hot&Cold function

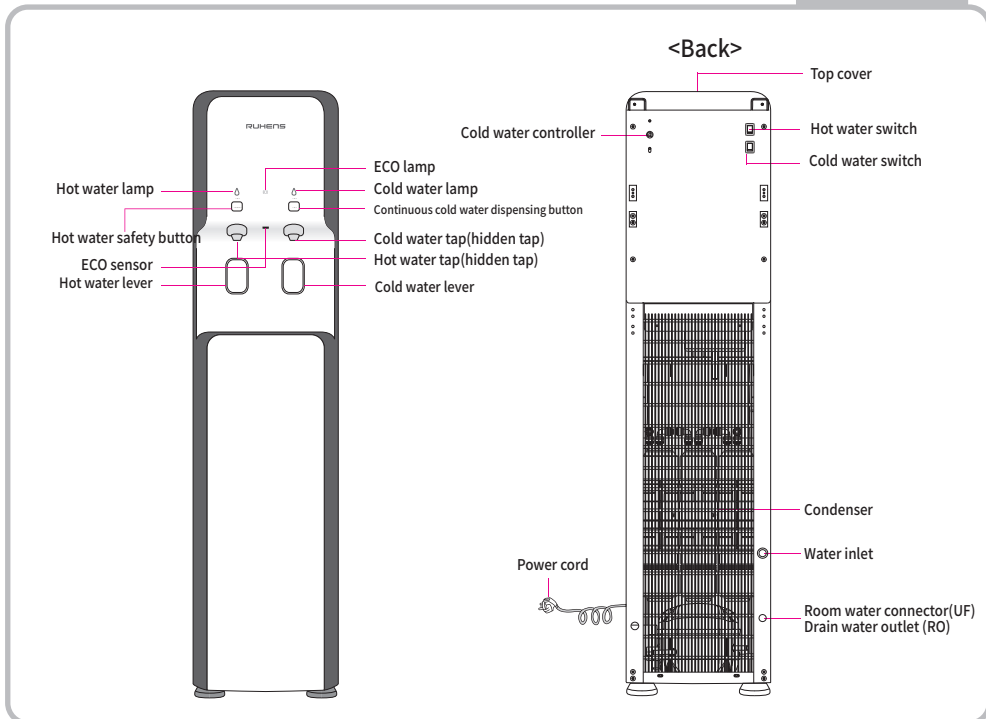

# NAME OF EACH PART

Model No / WHP-1680S,WHP-1680S\_RO

Hot&Cold function

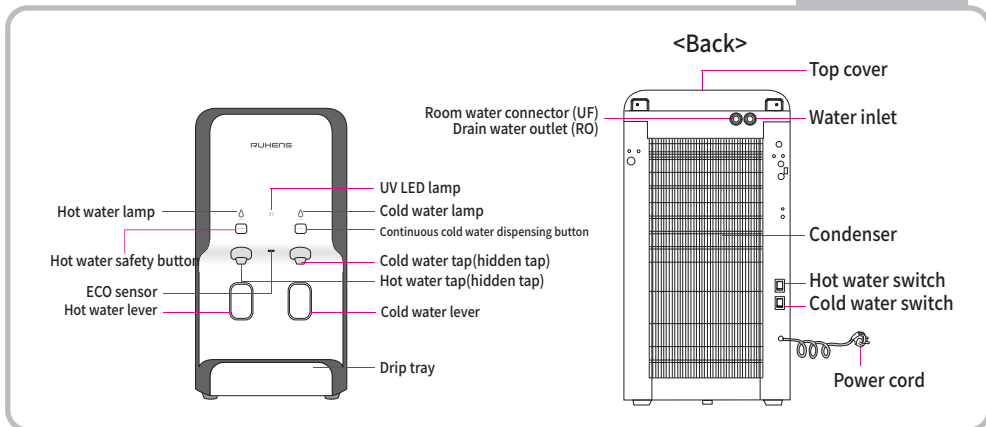

Model No / WHP-1680,WHP-1680\_RO

Hot&Cold function

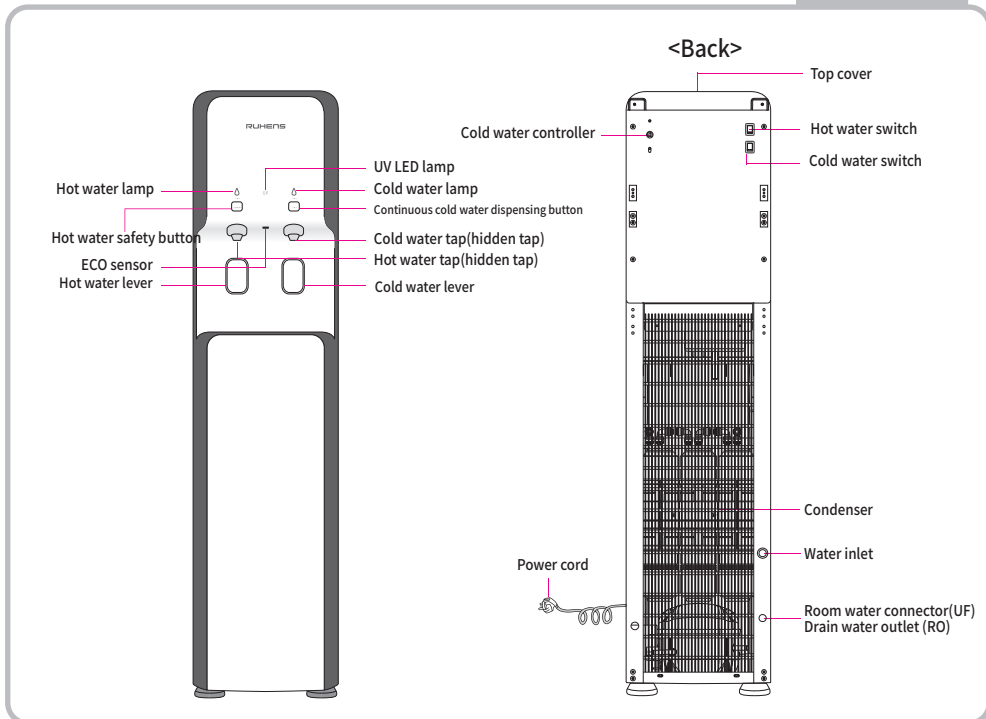

# INTERIOR

## Interior diagram / WHP-1670S/WHP-1670, WHP-1680S/WHP-1680

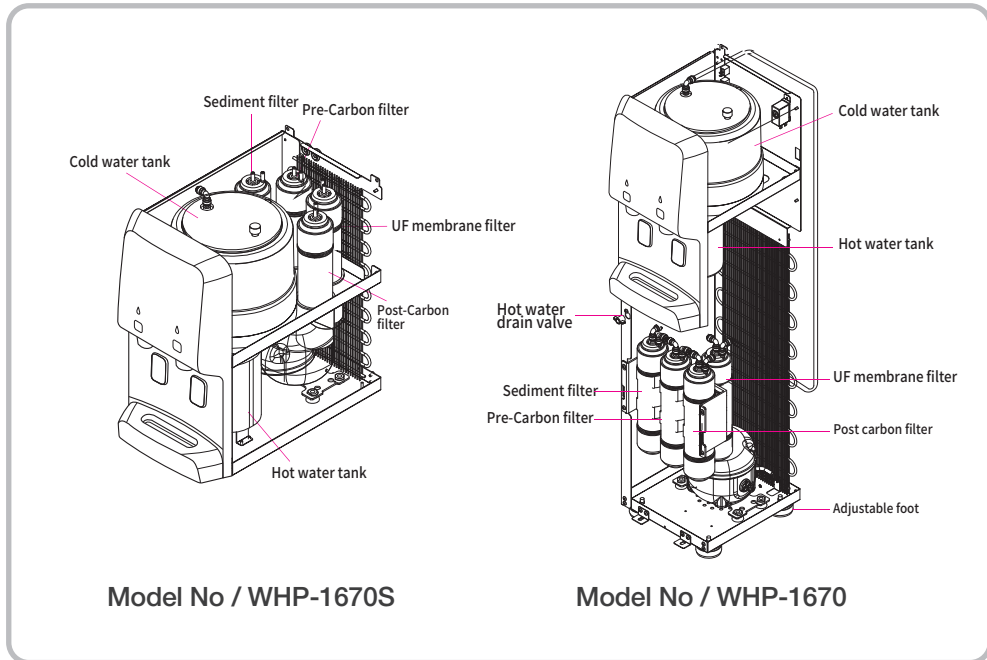

## Water filtration process / WHP-1670S/WHP-1670, WHP-1680S/WHP-1680

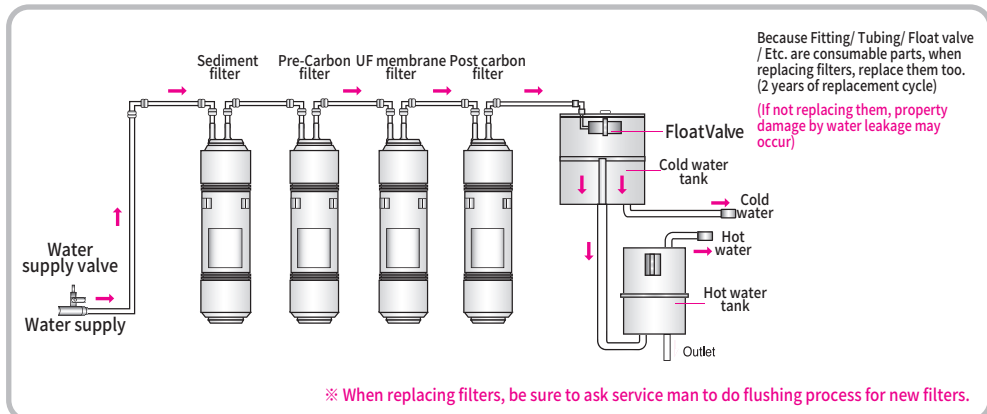

# INTERIOR

## Interior diagram / WHP-1670S\_RO/WHP-1670\_RO, WHP-1680S\_RO/WHP-1680\_RO

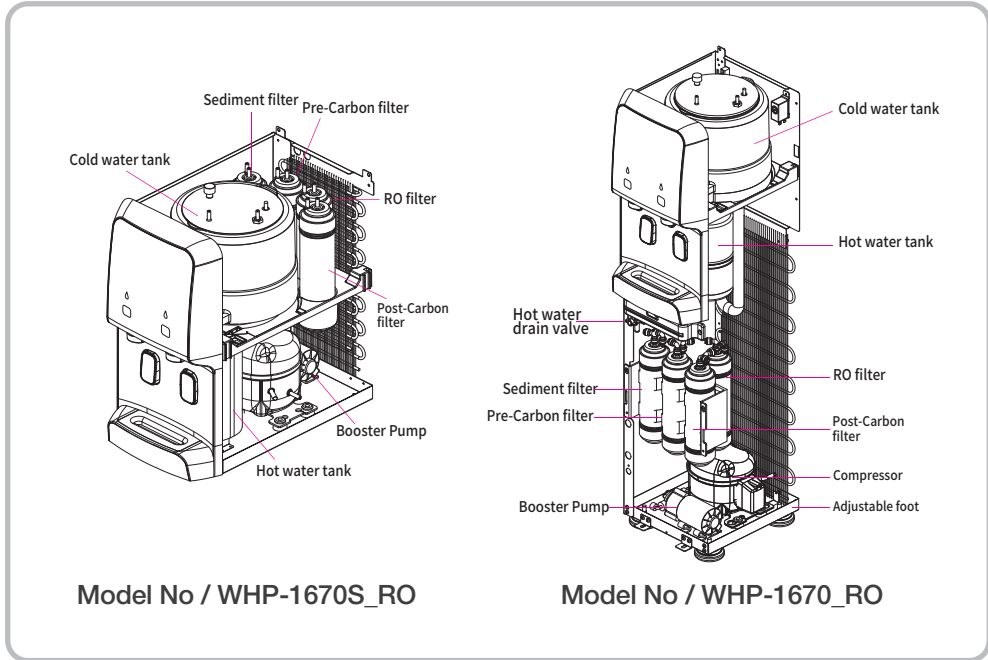

## Water filtration process / WHP-1670S\_RO/WHP-1670\_RO, WHP-1680S\_RO/WHP-1680\_RO

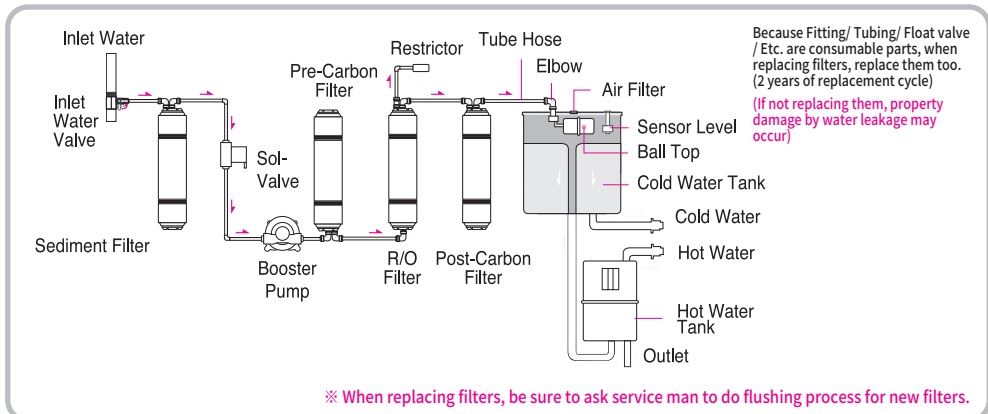

# UV LED SYSTEM

## ■ Self sterilization by UV LED

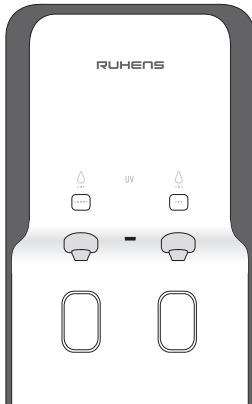

- UV LED sterilization is operated initially when the electronic power cord is plugged.  
There is no on/off S/W for UV LED operation and it is operated automatically.  
The function of UV LED could be deteriorated 5 years later after use.  
During operation of UV LED, the UV LED lamp flickers on and off.
- STERILIZATION CYCLE : 2 hours/1 day
  - ※ Please make sure to unplug power cord when opening the tank lid.
  - Failure to do so can cause a safety accident by the light of UV LED in the cold tank.

# ECO SYSTEM

## ■ What is ECO(illuminance sensor) function?

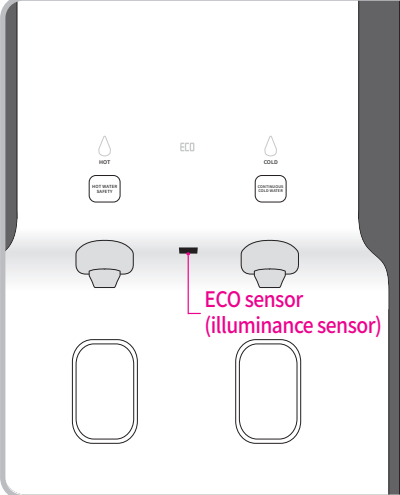

- ECO function helps save power consumption by sensing illuminance around the unit. When the illuminance around the unit darkens at night, the product automatically stops water heating & chilling and adjusts the brightness of display.
- When the illuminance around the unit brightens again, the sensor automatically stops ECO function and the product works normally.

※ About 20 mins for hot water and 60 mins for cold water are required to turn the hot&cold water temperature back to normal.

※ While the ECO function is being operated, ECO lamp flickers and the other lamps darken.

## ■ How to operate ECO function(illuminance sensor)

1. Touch the hot water safety button for more than 5 sec.
2. Then, the ECO lamp will be turned on and the function will be operated.

## ■ Precautions for operating ECO function

Because the ECO function is operated by sensing illuminance around the unit, do not install at dark or shady place.  
(ECO function may be operated at all time and water heating & chilling may not work.)

# HOW TO USE HOT&COLD WATER PURIFIER

## 1. Plug the power cord

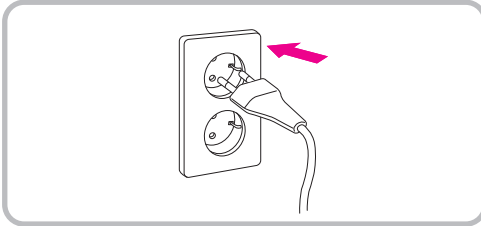

- Before plugging, please check if the voltage rate is matched.
- Before plugging, turn off the hot water switch.

## 2. Open the water supply valve

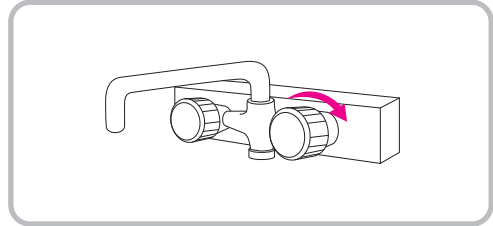

- If water supply valve is closed, the water purifier doesn't work.  
(Except in cases of going outside for a long time, leave the valve open.)

## 3. How to use

### 1) When power is supplied to the product

- ① WHP-1670(S) and WHP-1670\_RO(S) are turned on with 'beep' sound.
- ② WHP-1680(S) and WHP-1680\_RO(S) are turned on with lamp lighting and 'beep' sound.
- ③ After the unit is turned on, you can take normally filtered water.

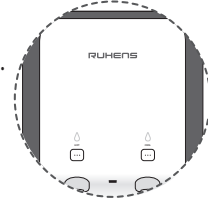

### 2) How to use hot water function

- ① Turn on the hot water switch at the back of the unit.
- ② Then the hot water lamp is turned on and hot water function works.
- ③ After hot water function starts to work, it takes 30 mins to get sufficiently heated water.
- ④ When the product is turned on, it takes 3mins to fill hot water tank with water and operate heater.
- ⑤ How to get hot water
  - After touch the hot water safety button, push the hot water lever within 3 sec.  
(Or after push the hot water lever, touch the button within 3 sec.) Then hot water comes out.
  - While hot water is coming out, get your hands off from the lever or touch the hot water safety button to stop hot water dispensing

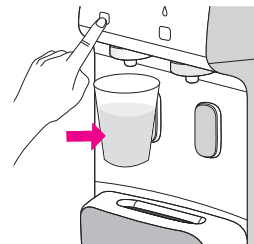
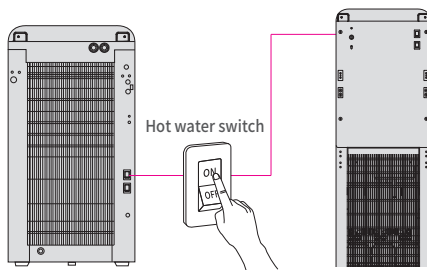

- When you want cold water only, turn the hot water switch off and save electric charge.

# HOW TO USE HOT&COLD WATER PURIFIER

## 2-1) How to lock hot water function

This function is for protecting children from burning themselves by careless hot water dispensing.

### ① How to lock

- Touch the hot water safety button 5 times to lock the hot water dispensing.
- After the lock is set, if you try to touch the hot water safety button to get hot water, the button doesn't work with "beep-beep" sound.
- If you push the hot water lever, the hot water lamp will be off to show the hot water dispensing function is locked.

### ② How to unlock

- If you touch the hot water safety button 5 times again, the lock is unlocked and the hot water function works again

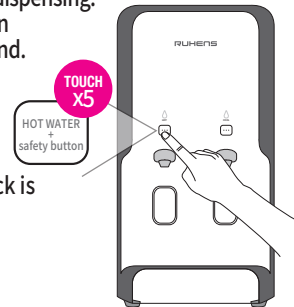

## 3) How to use cold water function

- ① If you turn cold water switch on, cold water function is operated.
- ② After the cold water function is operated, it takes 1 hour to get sufficiently chilled water.
- ③ How to get cold water
  - If you push the cold water lever, you can take cold water.
  - While cold water is coming out, if you get your hands off from the cold water lever, it stops.

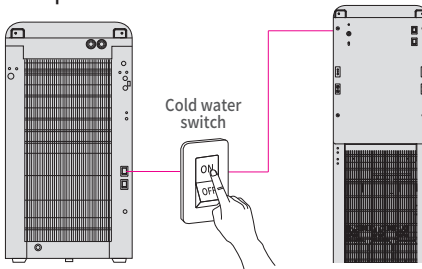

## 3-1) How to operate continuous cold water dispensing

- ① If you touch the continuous cold water button for more than 3 sec, cold water continuously comes out for 60 sec.
- ② Touch the button again to stop the continuous cold water dispensing.



### ⚠ Cautions

Before turn hot water switch on, make sure that water comes out from hot water tap.  
• It may cause malfunction.

- After intallation of the product, drain first 20 liters of water.
- If you don't use the product for a prolonged period, drain 1~2 liters of water before use again.



# FILTER REPLACEMENT

1. Before replacing filters, pull the power cord out and close the water supply valve.

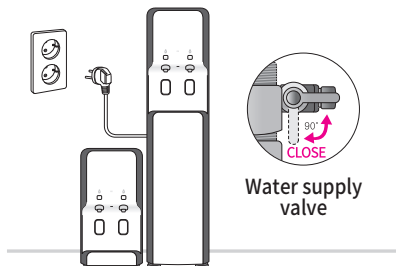

2. Remove drip tray.

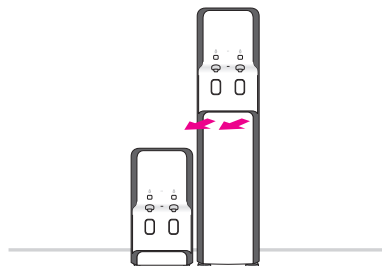

3. Push down the lower cover and pull it to the front and separate it.

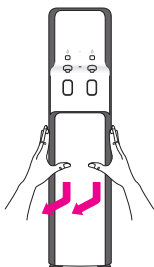

Model No / WHP-1670/WHP-1680

3-1. Loosen left and right screws of top cover at the back of the unit and separate the cover.

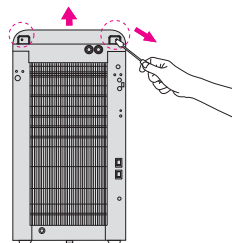

Model No / WHP-1670S/WHP-1680S

4. After replacing filters, reassemble parts in reverse order.

- After replacing filters, check if there is water leakage at connecting parts.
- Refer to Water filtration process(p.10,11) and keep the filtration order.

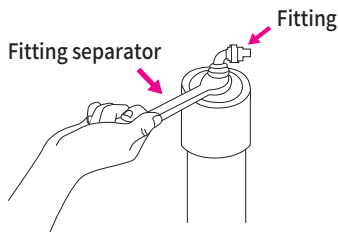

5. Open the water supply valve and plug the power cord.

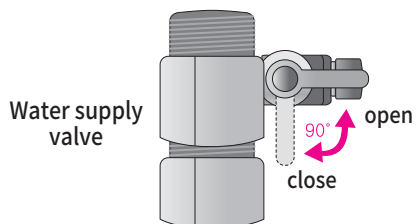

# FILTER REPLACEMENT

■ Before replacing filters, pull the power cord out and close the water supply valve.

- When using the unit for the first time or replacing filter, do water flushing process to each filter for more than 10 mins, until white, black or bubble water doesn't come out from the filter.

(Water Flushing : a process of cleaning inside of the filter)

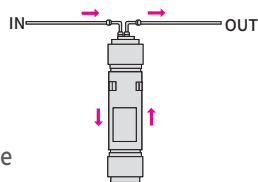

- After replacing carbon filter, black carbon dust may remain on the bottom of the unit.

(The dust is spilled from carbon filter which makes water taste fine and harmless.)

## Cautions

- According to the filter replacement cycle, replace filters regularly.
- If the filter is not regularly replaced, it could degrade the water quality.
- The filter replacement cycle may vary depending on feed water quality and consumption.
- When replacing filter, use our genuine one.  
(If not, we can not guarantee filter efficiency and water quality.)

※ We can not take responsibility for any damage caused by replacing filters by third party who is not our service man.

	Model no.	1step	2step	3step	4step
Filter	WHP-1670/ WHP-1680	Sediment filter	Pre-Carbon filter	UF membrane filter	Post-Carbon filter
	WHP-1670_RO/ WHP-1680_RO			RO membrane filter	
Replacement cycle	WHP-1670/ WHP-1680	4 months	8 months	20 months	12 months
	WHP-1670_RO/ WHP-1680_RO			24 months	

- When replacing filters, be sure to ask service man to do flushing process to new filters for more than 10 mins. (If not, it could degrade water quality)
- Even if your water consumption is not much, following regular filter replacement cycle is recommended.
- Above filter replacement cycles are based on normal feed water condition and 1500 liters of water purifying efficiency.  
(The cycle doesn't mean quality guarantee period.)
- The period is based on 10ℓ use in a day for house use (4 people based)

# SOLUTIONS TO COMMON PROBLEMS

## ■ Check the followings before asking A/S

Problem	Cause	Solution
Insufficiently heated water	Low power supply	Check voltage rate.
	Hot water switch off	Check if hot water switch at the back of the unit is on.
Insufficiently chilled water	Low Power supply	Check voltage rate.
	Cold water switch off	Check if cold water switch at the back of the unit is on.
No water comes out	Filter need to be replaced	Check filter replacement cycle and contact customer service center.
	Water supply cut off	Unplug the power cord. When the water is supplied again, use the unit again.
	Connecting hose bending	If there is a bending in connecting hose, straighten the part.
No heating	Shut down by temperature controller or heater malfunction.	After turn the hot water switch off, contact customer service center. (When water tank is overheated, the temperature controller cut off the power supply to heater)
Abnormal hot & cold water temperature	Too much water consumption	When much of water is continuously taken from the unit, hot & cold water temperature become abnormal. Do not take water from the unit for 5~6 mins, then you can take normal hot & cold water.
Noisy sound	Working sound of compressor	When the compressor works or stops, it makes sound like water flowing. The sound comes from refrigerant flowing, so it is not a problem.

# SOLUTIONS TO COMMON PROBLEMS

■ Check the followings before asking A/S

Problem	Cause	Solution
Decreased water production	filter need to be replaced	Replace filter.
	Low pressure feed water	If low pressure water is supplied to the unit, less amount of filtered water is produced.
Water leakage	Poor water pipe connection	Close the water supply valve and contact customer service center.
Unpleasant water taste or odors	Poor cold water tank cleaning	Clean the cold water tank. (Please refer to the cleaning cycle on p20.)
	Wrong usage environment for a long period	Replace all the filters and clean the cold water tank.
Particle in water	It is bubble caused by water dispensing	After 1 minute, if the particle still remains, contact customer service center.

- ※ If a problem comes up, contact a customer service center and get filter replacement or repair service.
- ※ We can not take responsibility for any damage caused by replacing filters by third party who is not our service man.

# CLEANING METHOD & CYCLE

## Hot tank & Cold tank

**Caution** Do not try to clean inside of the product by yourself.  
Ask our service man to do. It could cause electric shock.

1. Close water supply valve and pull the power cord out.
2. Drain all the water in the cold tank through cold water tap
3. Stand type : Separate front lower panel from the product and completely drain by opening drain valve.  
Table top type: Separate small cover of side panel and completely drain by opening drain valve.

(Be careful not to get burned by the hot water, when opening the drain valve.)

4. Loosen left and right screws at the back of the unit and separate top cover. Then, separate cold tank cover in the unit.  
(When separating tank cover, be careful not to damage rubber packing of it. The cold tank is made of stainless steel, so be careful not to hurt your hands)

5. Clean inside of the cold tank pouring water into it. Then, close water drain valve and reassemble cold tank cover.
6. Open the water supply valve and check water leakage when cold tank is fully filled with water. Then, reassemble the top cover.
7. Keep checking operation and water leakage state for a day.  
(If there is problem, contact customer service center.)

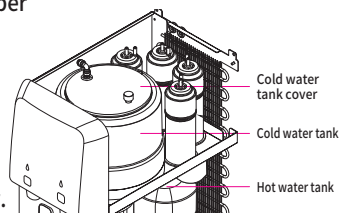
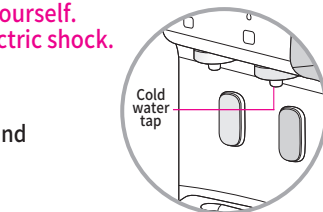

★ If you need cleaning service, after not using the unit for a long time, contact customer service center.

## Cleaning Cycle

Cleaning	Cycle	method
Exterior	once a week	Clean the exterior with water-soked, soft cloth. (Never use Benzene, gasoline or thinner to clean the unit.)
Drip tray	frequently	Frequently clean the drip tray with a neutral detergent.
Water tap	once a day	Loosen hidden taps counterclockwise and separate it. Then, clean the hole of the taps with sterilized swap and wipe the taps with water soaked cloth. After cleaning, tighten the taps again.
Fitting / Tubing	more than once within 2 years	When replacing filter, check if Fitting and Tubing are fine. If necessary, we serve them for free.

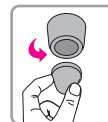

# PRODUCT SPECIFICATIONS & FILTRATION SYSTEM

## ■ PRODUCT SPECIFICATIONS

Product name	HOT& COLD WATER PURIFIER	
Model no.	WHP-1670, WHP-1680 WHP-1670_RO, WHP-1680_RO	WHP-1670S, WHP-1680S, WHP-1670S_RO, WHP-1680S_RO
Power supply	AC 220V~240V/50Hz	
External dimensions	260(W) * 360(D) * 1100(H)	260(W) * 480(D) * 495(H)
Recommended water consumption	10ℓ / a day (4 people based)	
Hot water capacity	about 1.8ℓ	about 1.4ℓ
Cold water capacity	about 3.0ℓ	
Heater power consumption	400W	
Moter power consumption	90W(0.6A)	
Cold water temperature	about 4°C~12°C	
Hot water temperature	about 70°C~90°C	
Service condition	Permitted Water Pressure	127~294 kPa (18~43 PSI)
	Permitted Water Temperature	5~35°C
	Usable feed water	tap water
Product usage environment	Indoor (House/ office)	

## ■ Filtration System

Model No.		WHP-1670(S)	WHP-1680(S)	WHP-1670RO(S)	WHP-1680RO(S)
Filtration system (filter component)	Sediment Filter(non-woven fabric)	○	○	○	○
	Pre-Carbon filter(activated carbon)	○	○	○	○
	UF membrane filter (ultrafiltration membrane)	○	○		
	RO membrane filter			○	○
	Post-Carbon filter(activated carbon)	○	○	○	○

- Exterior and specification of the product could be changed for performance improvement.
- Filter replacement cycle could be changed depending on water consumption.
- Manufacturer : WONBONG CO., LTD. 171, Balsan-ro, Yangchon-eup, Gimpo-si, Gyeonggi-do, Korea

# PRODUCT WARRANTY

## PRODUCT WARRANTY

Product	Model	<input type="checkbox"/> WHP-1670(S)	
		<input type="checkbox"/> WHP-1680(S)	
		<input type="checkbox"/> WHP-1670_RO(S)	
		<input type="checkbox"/> WHP-1680_RO(S)	
	Date of Manufacture		
Date of Purchase	Year	Month	Day
Customer's Name			
Dealer's Name			

### WARRANTY GUIDE

1. The warranty period is 12 months from date of purchase.
2. In following case, the product will be repaired at cost.
  - a) After expiry of free warranty period.
  - b) Malfunction of caused by careless or abnormal use.
  - c) Malfunction of caused by natural disaster.
  - d) In case this manual has been lost.

 **WONBONG Co., Ltd.**

### Head Office & Factory

171, Balsan-ro, Yangchon-eup, Gimpo-si,  
Gyeonggi-do, Korea

Tel: 82-2-6343-5031

Fax: 82-2-6343-5049

# MEMO

RUHENS

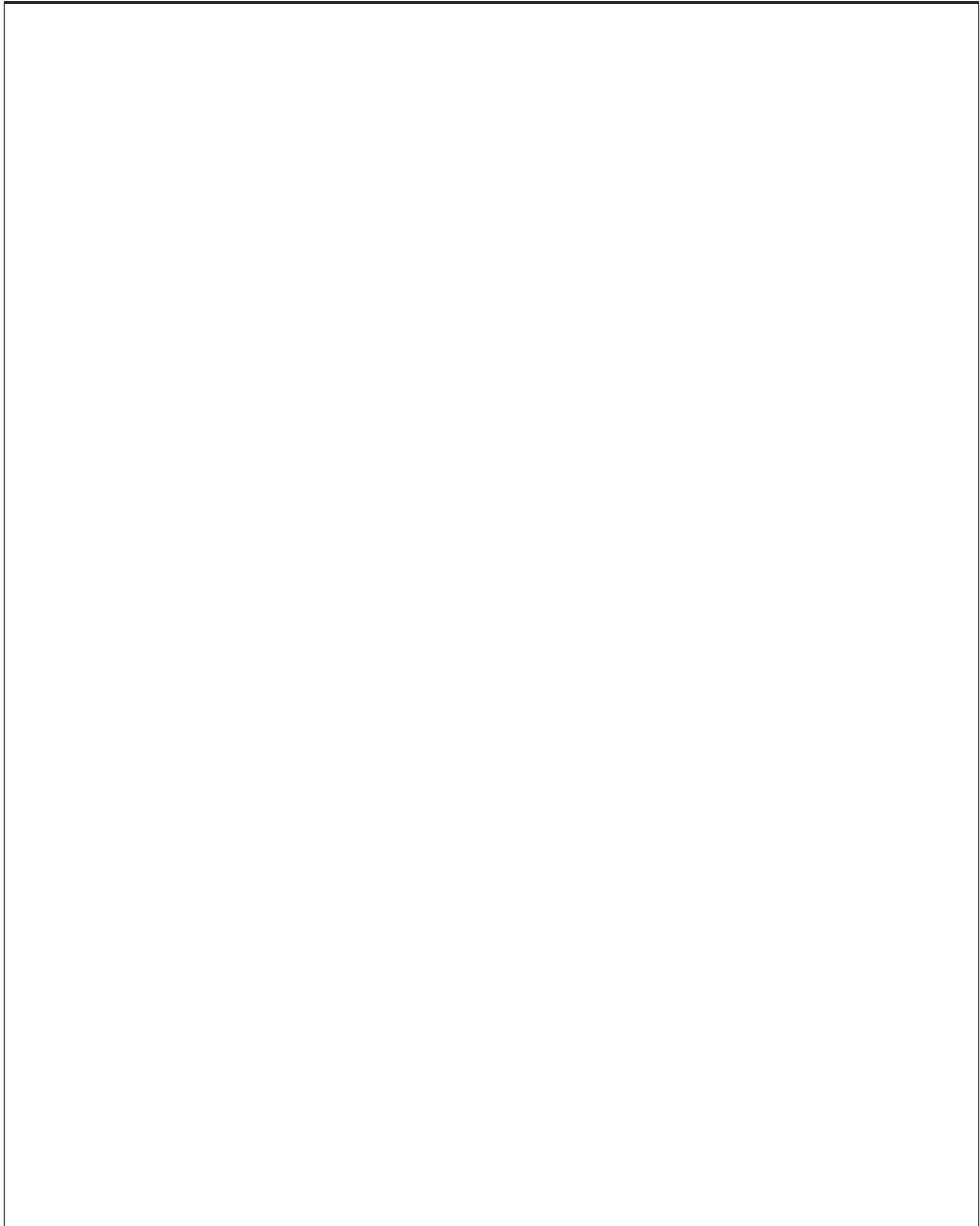
A large, empty rectangular box with a thin black border, occupying the majority of the page below the header. It is intended for the user to write the content of their memo.