

RUHENS

HOT & COLD WATER PURIFIER OPERATION MANUAL

To keep the best working condition and guarantee long life,
read this manual carefully before you operate this equipment.

WHP-300
WHP-300S / WHP-340S

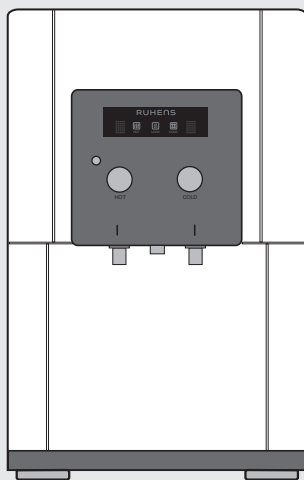
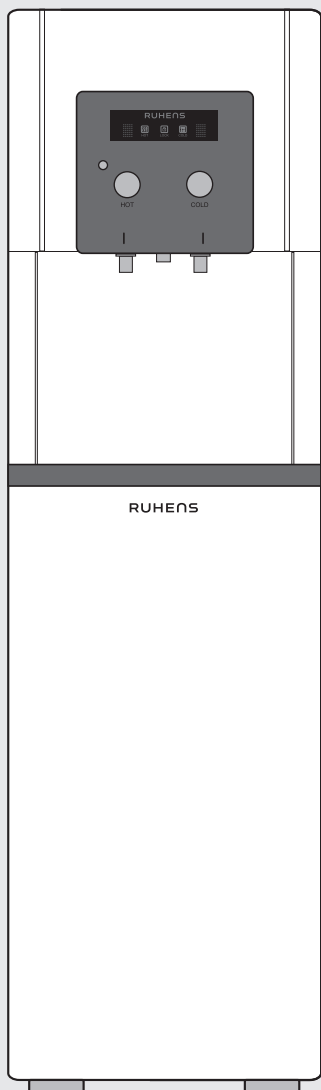

Contents

Characteristics

- 1) Electric control button type faucet
- 2) Hot safety lock function for children
- 3) Illumination and beep when dispensing the water
- 4) Antibacterial plastic Hygiene Guard
Hygiene Guard was made by Antibacterial plastic to minimize the bacterial contamination caused by air.
It can be easily changeable by turning the Hygiene Guard to the right.
- 5) Drain valve in front side

1	PRECAUTIONS	3~5 page
2	INSTALLATION	6 page
3	NAME OF EACH PART	
	• WHP-300	7 page
	• WHP-300S/340S	8 page
4	PRODUCT USE (Display & Button)	9~11 page
5	FILTRATION SYSTEM	
	• Filter Function	12 page
	• Filter Name & Expected Replacement	12 page
	• Water Flow Diagram	12 page
6	SOLUTION TO COMMON PROBLEM	13 page
7	SPECIFICATIONS	14 page
8	WARRANTY CARD	15 page

1-1. PRECAUTIONS

1. Do not insert a plug in a loose wall outlet.

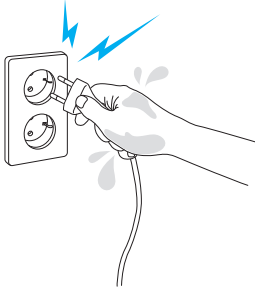

2. When unplugging the power cord, do not pull on the cord itself but pull on the plug.

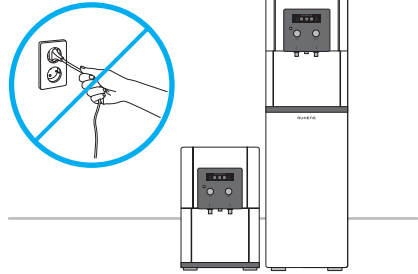

3. Do not plug in with other electrical appliance, the plug should be rated for more than 10A.

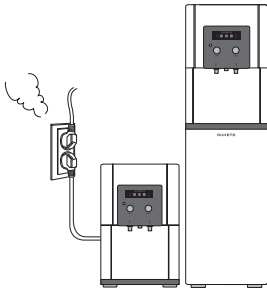

4. Do not step on the power cord or do not bend the cord.

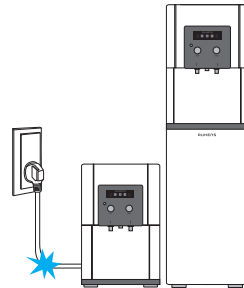

5. Do not place the unit near source of heat and do not expose to direct sunlight.

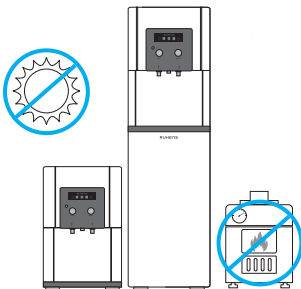

6. Do not expose the unit to moisture rain, or dust, do not place it at outdoor or bathroom.

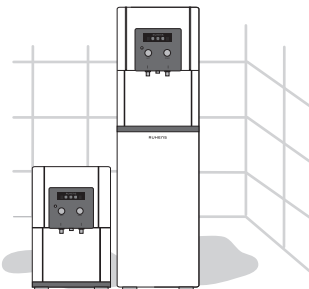

1-2. PRECAUTIONS

7. Place to the hard and flat floor.

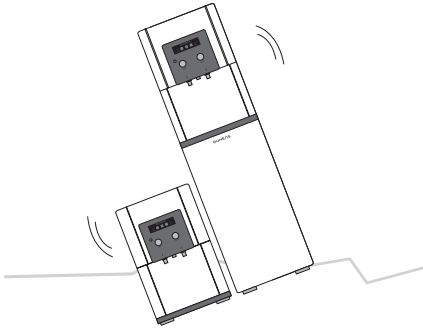

8. The temperature of installation area should be maintained between 39°F(4°C) and 90°F(32°C).

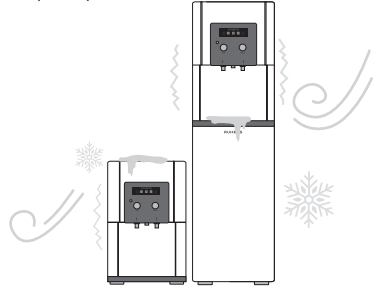

9. The temperature of water supply should be maintained between 39°F(4°C) and 95°F(35°C).



35°C

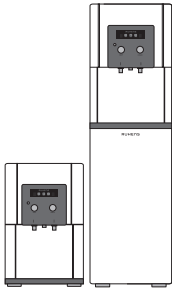

10. Maintain sufficient distance from wall at least 6 inches.

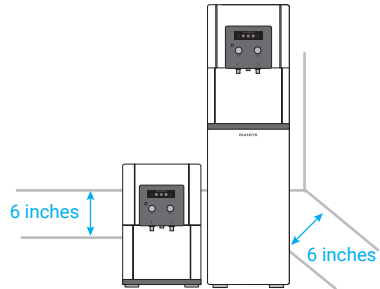

11. Do not operate the unit for more than 30 minutes after it is moved to new location.

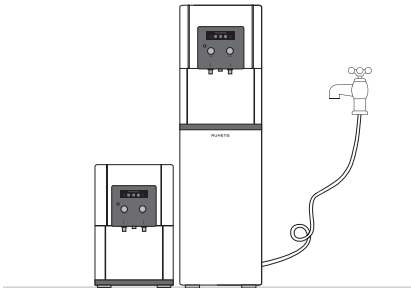

12. Do not take the unit to pieces when it is found to be defective. Please call the service center.

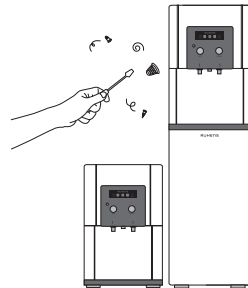

1-3. PRECAUTIONS

13. Do not use alcohol or aerosol, wax, benzene to prevent the deformability.

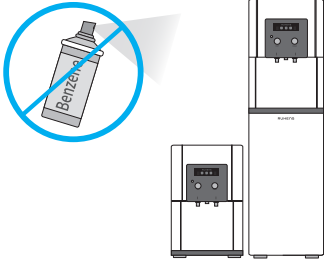

14. Do not place objects on the top of the unit to avoid damaging.

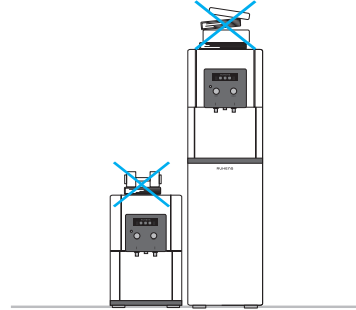

15. Do not move the unit while it is operating.

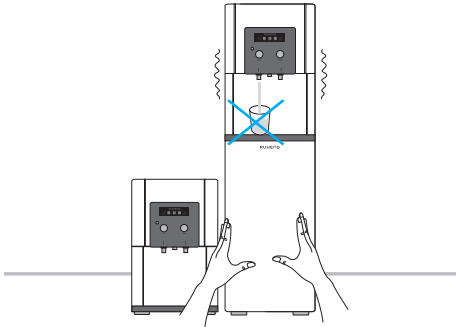

2. INSTALLATION

1. Gently remove the unit from the carton box.
2. Remove all shipping tape used to secure parts.
3. Place the unit on flat and hard floor.
4. Remove the bolts and then open the top cover.
(In the case of WHP-300 open the front cover low.)
5. Take out the 2nd filter and the 4th filter from the unit.
Flush the Pre-carbon(2nd) filter and Post-carbon(4th) filter for 5 minutes.
6. Assemble the filters to the unit again.
7. At the condition that the water supply valve is closed, connect the tubing hose (1/4") between feed valve and inlet of the unit.
8. Open the feeding valve after completing installation.
9. Plug in the unit. (AC 220-240V, 50 / 60Hz)
10. Turn on the power switch of the rear side.
11. Confirm feed water supplies.
12. Close the top cover and fasten with bolts.
(In the case of WHP-300, close the front cover low.)

■ To avoid user damaging, product should be installed by service man.

3-1. NAME OF EACH PART

WHP-300

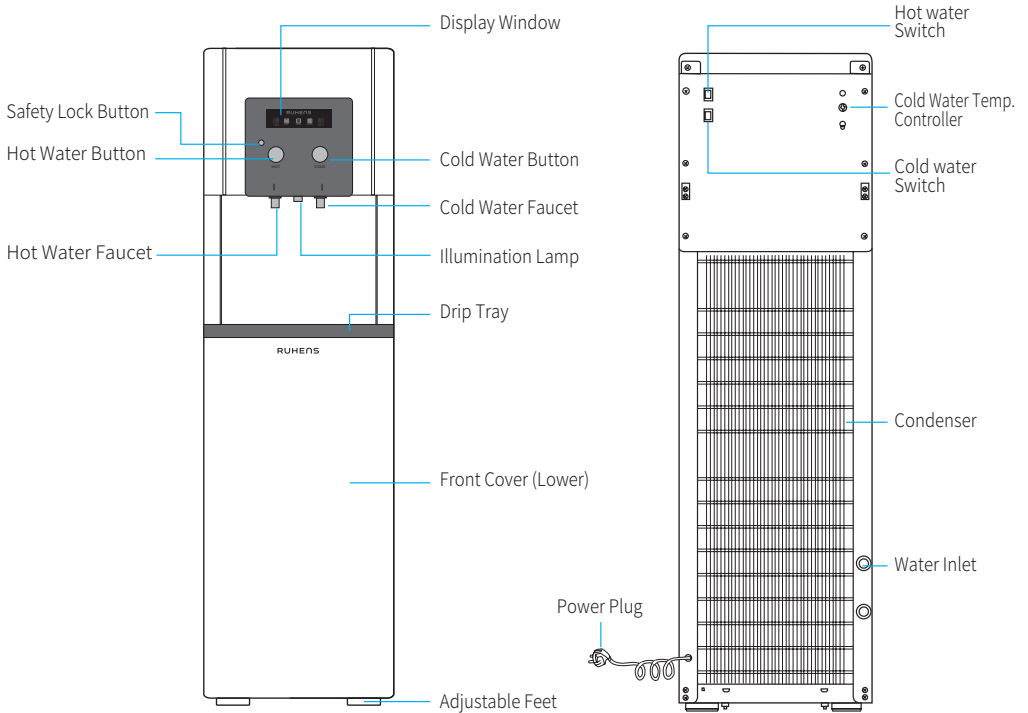

3-2. NAME OF EACH PART

WHP-300S / 340S

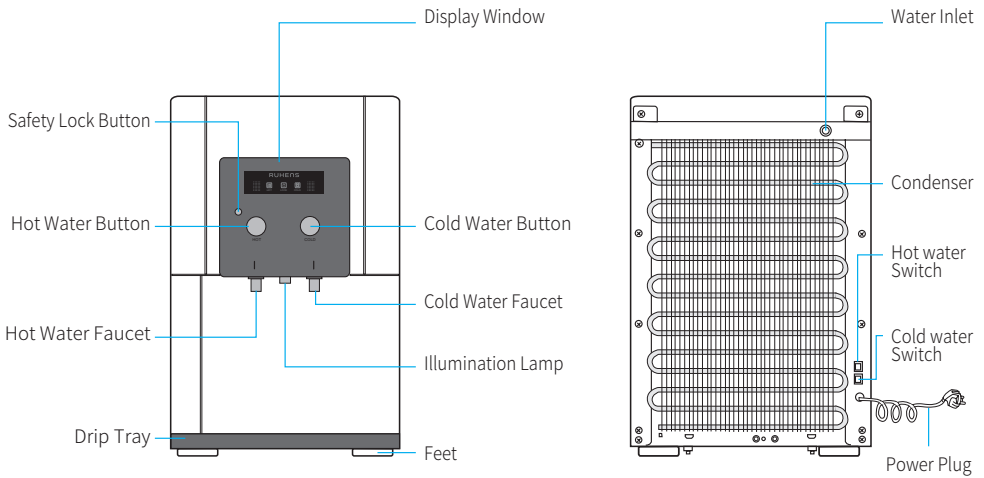

4-1. PRODUCT USE

DISPLAY & BUTTON

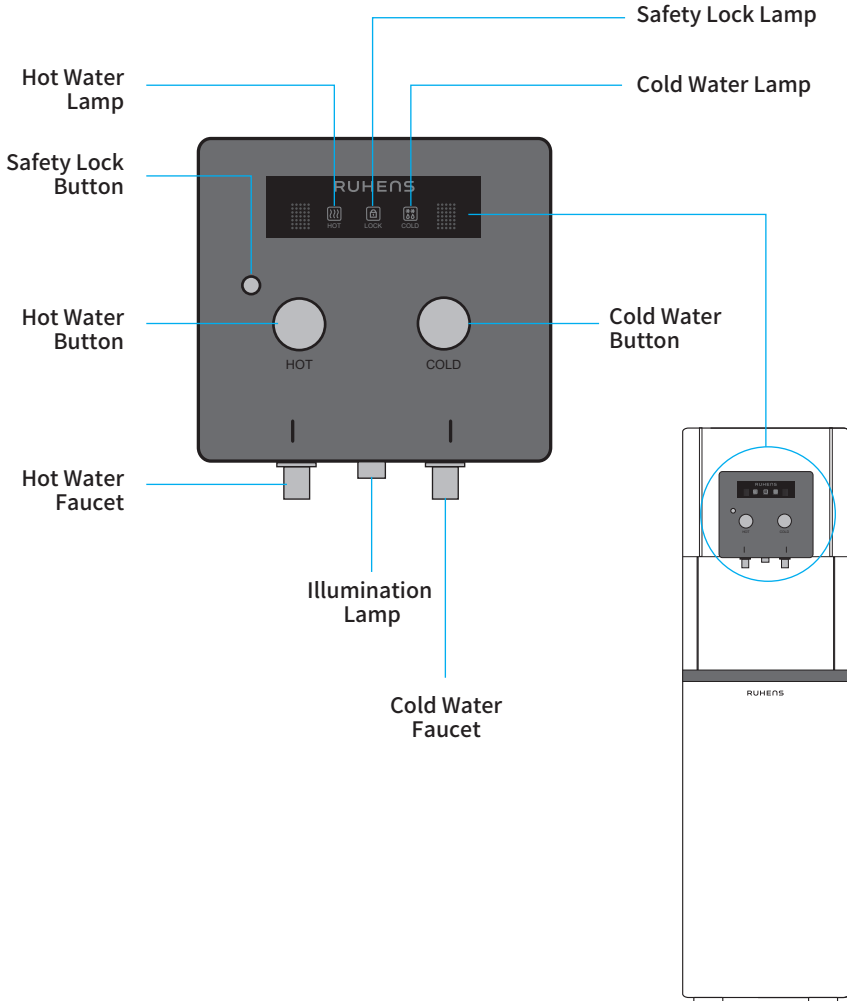

4-2. PRODUCT USE

Power

Front display lamp will turn on after plugging in.

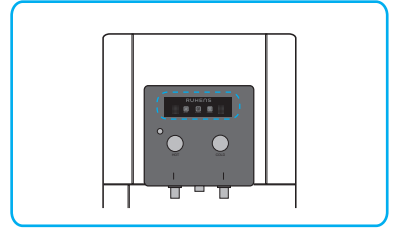

How to operate hot water function

- How to activate hot water function

- 1) Turn on Hot water switch on the rear side of the machine.
- 2) Hot water lamp will turn on.
- 3) Using Hot water is available after 20 minutes.
- 4) Hot water temperature is controlled by temp controller automatically.

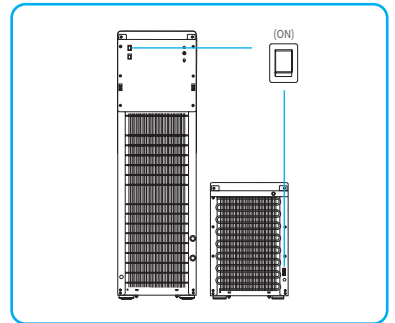

- How to use hot water function

- Method 1) Press safety lock button first then press Hot water button within 3 sec.
- Method 2) Press the safety lock button and Hot water button at the same time.
- Method 3) Keep pressing Hot water button then pressing safety lock button.

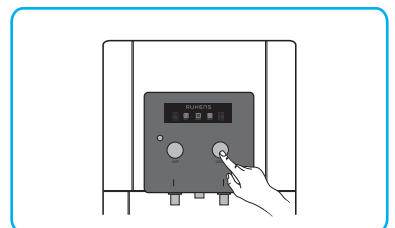
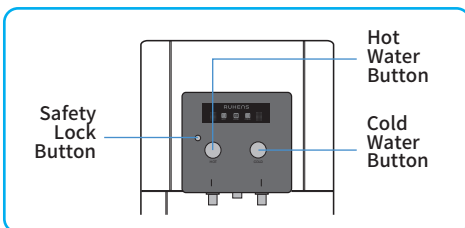

4-3. PRODUCT USE

How to operate cold water function

- How to activate cold water function

- 1) Turn on Cold water switch on the rear side of the machine.
- 2) Cold water lamp will turn on.
- 3) Using Cold water is available after 60 minutes.
- 4) Cold water temperature is controlled by temp controller automatically.

- How to use cold water function

Cold water will be dispensed during pressing the cold water button.

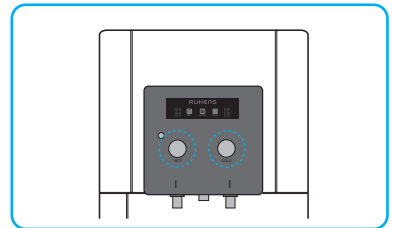
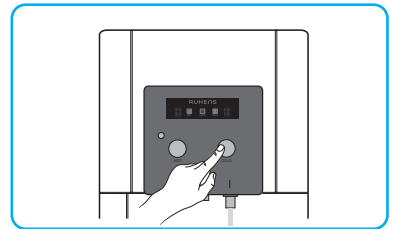
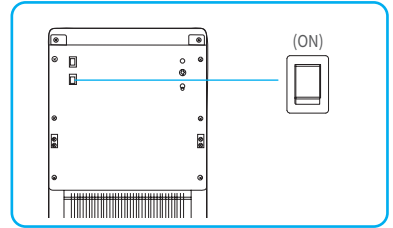

Illumination Lamp

Illumination lamp will turn on during pressing safety lock button or dispensing Hot/Cold water. It will turn off automatically.

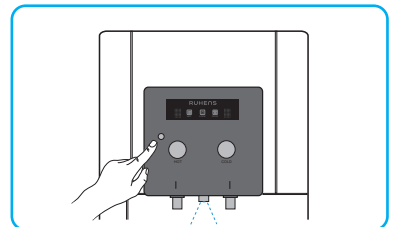

5. FILTRATION SYSTEM

Filtration System

- 1) 1ST Step : Sediment Filter**
Removes more than 5 micron sized substances like rust, sand and dust.
- 2) 2ND Step : Pre-carbon Filter**
Removes harmful chemicals such as cancer-causing materials, synthetic insecticide and chlorine.
- 3) 3RD Step : U/F Membrane Filter**
Removes minute harmful chemicals more than 0.1 ~ 0.4 micron such as bacteria, virus, etc.
- 4) 4TH Step : Post-carbon Filter**
Makes water tasteful by eliminating unpleasant odor, and bad taste dissolved in water.

Filter Name & Expected Replacement

Filter Name	Expected Replacement
1st Step : Sediment Filter	Approximately Per 6 Months
2nd Step : Pre-carbon Filter	Approximately Per 6 Months
3rd Step : U/F Membrane Filter	Approximately Per 18 Months
4th Step : Post-carbon Filter	Approximately Per 12 Months

Water flow diagram

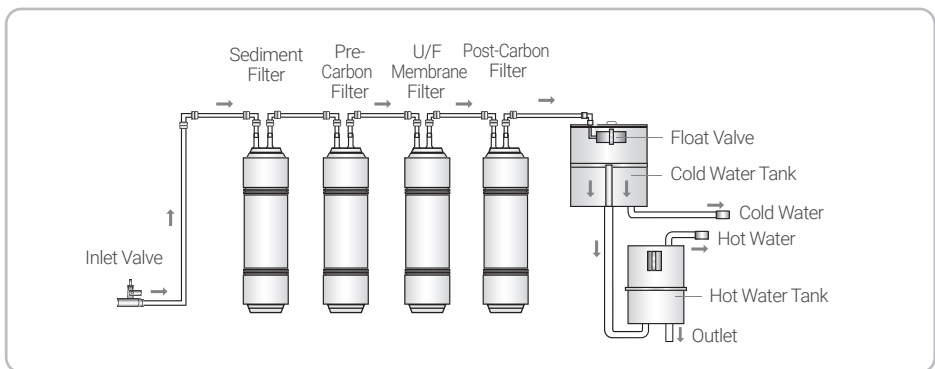

6. SOLUTION TO COMMON PROBLEM

Problem	Cause	Solution
Do not work	<ol style="list-style-type: none"> 1. Electrical power supply is wrong. 2. Power switch is off. 3. Power cord is bad. 4. Fuse is out. 	<ol style="list-style-type: none"> 1. Confirm electric power supply. 2. Turn on the power switch. 3. Change into a good quality cord. 4. Apply a new fuse.
Insufficiently chilled water	<ol style="list-style-type: none"> 1. Cold switch is off. 2. Airing at the rear side is bad. 3. Temperature of supplied water is too hot. 	<ol style="list-style-type: none"> 1. Turn on the cold switch. 2. Maintain at least 15cm from wall for a good ventilating. 3. Temperature should be below 30°C.
Insufficiently heated water	<ol style="list-style-type: none"> 1. Hot switch is off. 2. Water level of the storage tank is too low. 	<ol style="list-style-type: none"> 1. Turn on the hot switch. 2. Confirm the water supply.

7. SPECIFICATIONS

Product Name	Hot and Cold Water Purifier	
Model No.	WHP-300	WHP-300S/340S
External Dimensions	320(W) x 340.5(D) x 1096(H)	320(W) x 448(D) x 496(H)
Weight	Abt. 30kg	Abt. 26kg
Compressor	1/10HP Sealed Type	
Condenser	Wire Type	
Motor Power Consumption	120W	
Heater Power Consumption	430W (At. AC 220V)	
Refrigerant	R-134a	
Cold Water Tank	1.72 Liters	1.72 Liters
Cold Water Capacity	20 Cups at 39~53°F	
Temperature Control	Thermostat	
Cooling	Forced Cooling Type	
Hot Water Tank	1.76 Liters	1.4 Liters
Hot Water Capacity	18 Cups at 169~194°F	
Heater	Sheath Heater	
Temperature Control	Bi - Metal	
Storage Tank	1.14 Liters	
Overheat Protection Device	Bi - Metal	
Power Cord Length	2M	
Front Cover	ABS	
Working pressure	3.5kgf/cm ² (Max) (0.35MPa)	
Working temperature	5 ~ 30°C	
Climate	N Class	
Rated Voltage	AC 220-240V , 50/60Hz	



PRODUCT WARRANTY CARD

This product has passed the strict quality control and inspection processes of technicians, passed the inspection by the international Conformity Certification Program.

If the product is found to be defective, or goes out of order during normal usage within the warranty period, it will be repaired, and/or defective parts replaced, free of charge.

WARRANTY GUIDE

1. The warranty period is 12 months from the date of purchase.
2. In the following cases, the product will be repaired at cost.
 - a) After expiry of free warranty period.
 - b) Malfunction caused by careless or abnormal use.
 - c) Malfunction caused by natural disaster.
 - d) Warranty card has been lost.

Product	Model	WHP-300		
		WHP-300S / 340S		
	Type approval No.			
	Date of Manufacture			
Date of Purchase	Year	Month	Day	
Customer's Name				
Dealer's Name				

 **WONBONG Co., Ltd.**

Head Office & Factory

171, Balsan-Ro, Yangchon-Eup, Gimpo-Si, Gyeonggi-Do, Korea

Tel : 82-2-6343-5031 Fax : 82-2-6343-5049