

**We cannot take any responsibility
for any damage caused by not using
our genuine filter or part.**

HOT & COLD WATER PURIFIER OPERATION MANUAL

To keep the best working condition and guarantee long life,
read this manual carefully before you operate this equipment.

WHP-1800
WHP-1800_R/O
WHP-1800S
WHP-1800S_R/O

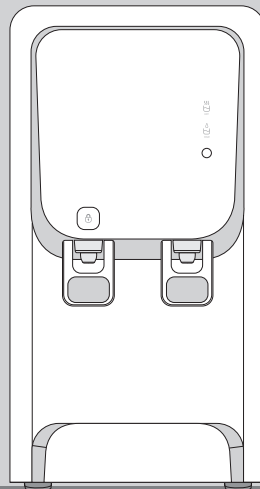
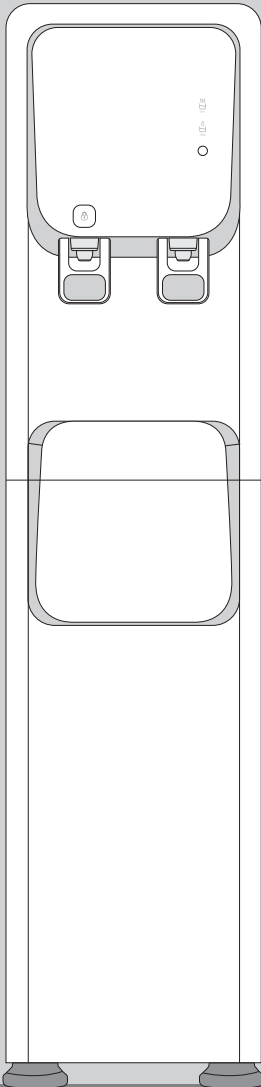

1. Name of each part (Exterior)

Model No / WHP-1800S, WHP-1800S_R/O

Hot&Cold function

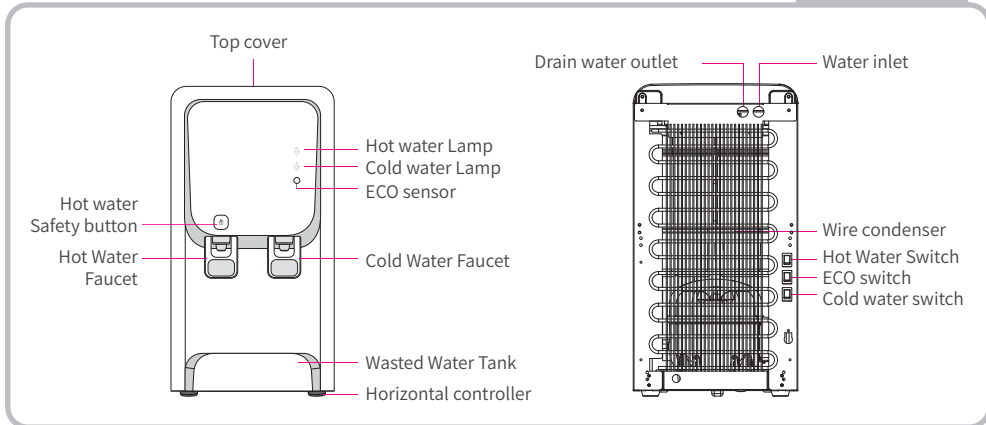

Model No / WHP-1800, WHP-1800_R/O

Hot&Cold function

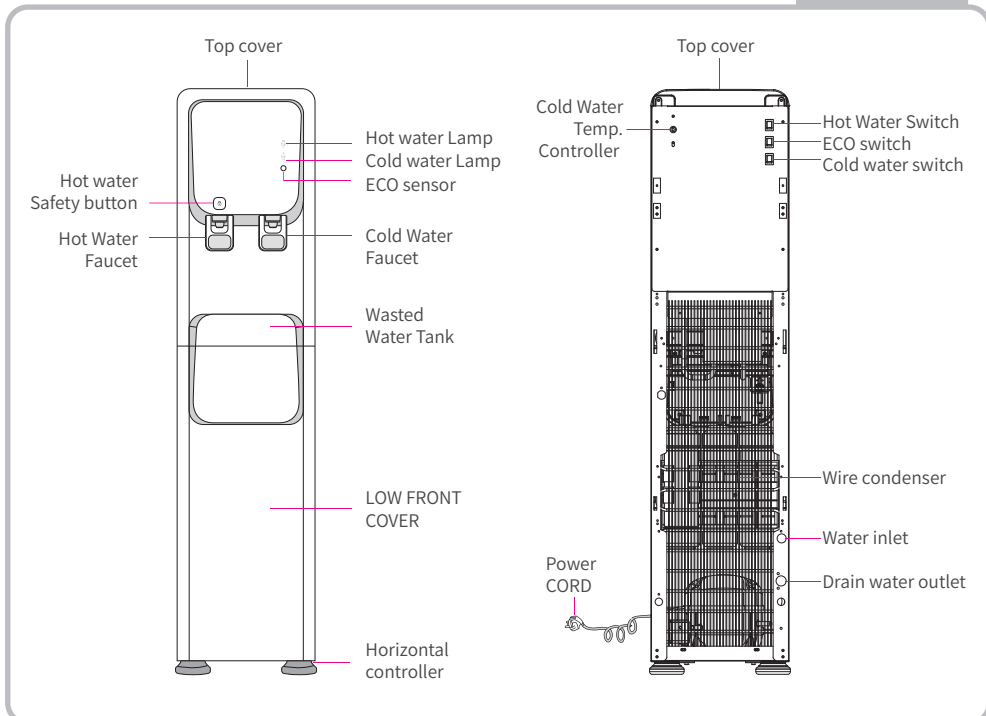

2. Interior Structure

U/F Filtration system

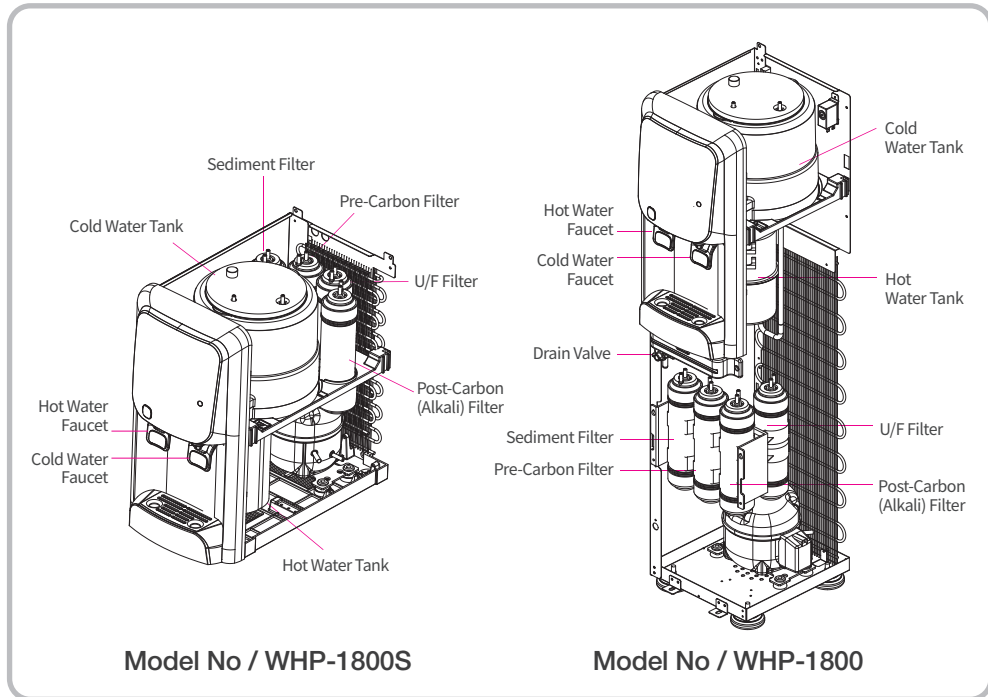

U/F Purifying system

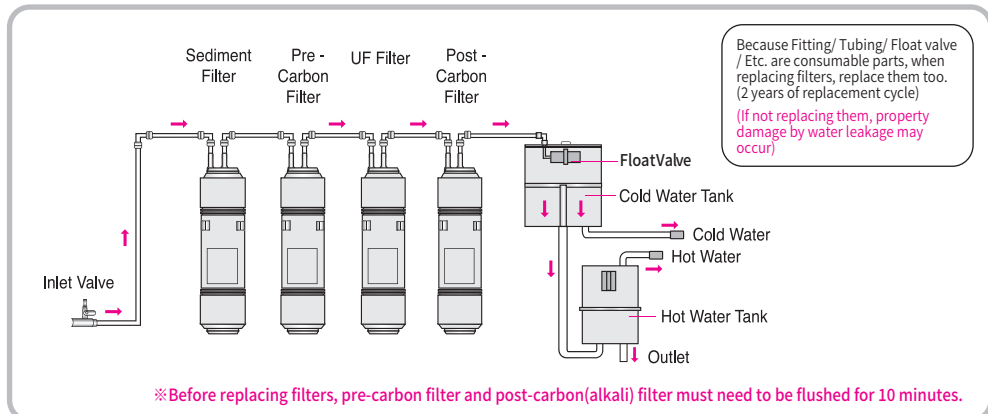

2. Interior Structure

R/O Filtration System

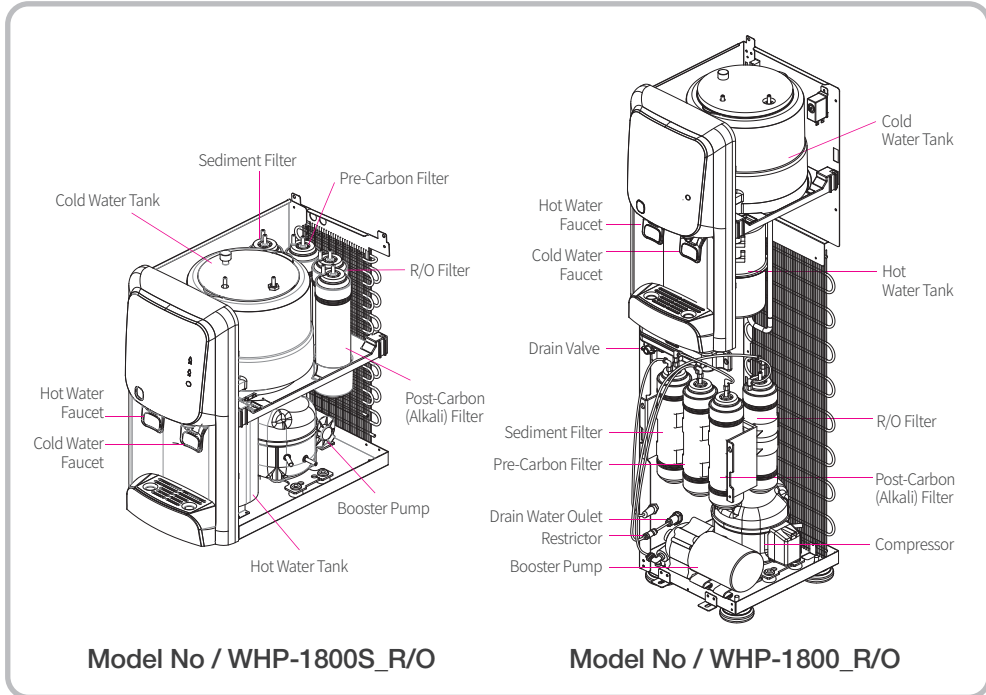

R/O Purifying System

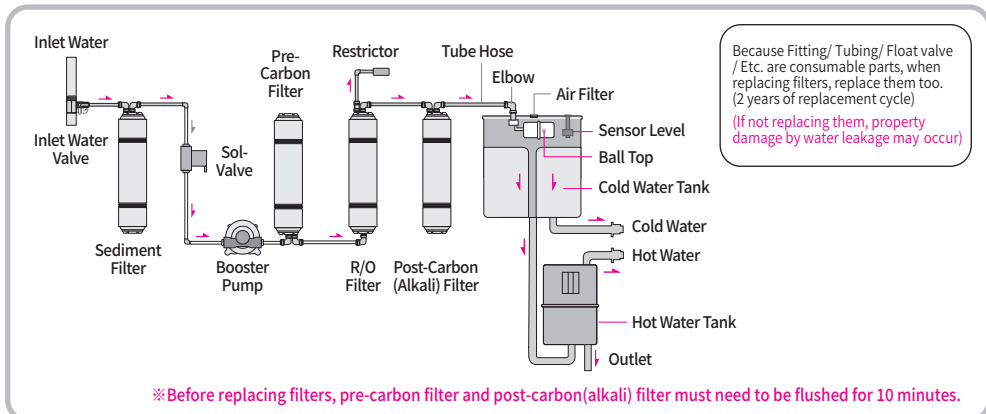

3. Precautions to ensure safe usage

1. Do not insert a plug in a loose wall outlet.

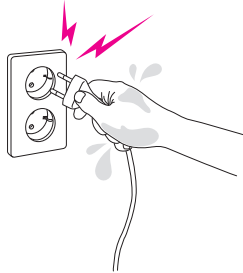

2. Check the electric power. Do not plug in, except power source is on the correct rated-voltage.

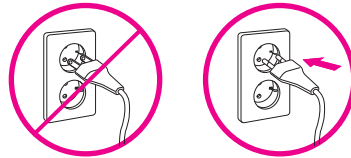

- Failure to follow this instruction may cause electric shock or fire.

3. Do not share a plug with other electrical appliance. The plug should be rated for more than 10A.

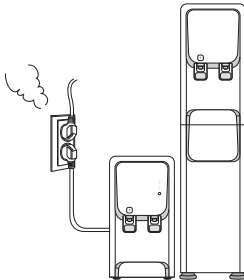

4. When unplugging the power cord, do not pull on the cord itself-but pull on the plug.

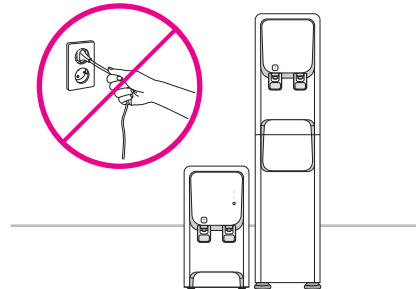

5. Do not expose the unit to moisture rain, or dust. Do not place it at outdoor or bathroom.

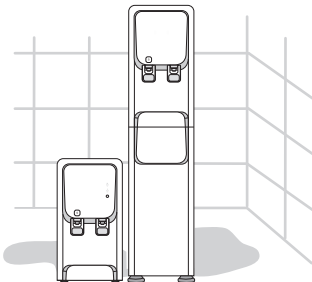

6. Maintain sufficient distance from wall, at least 20cm.

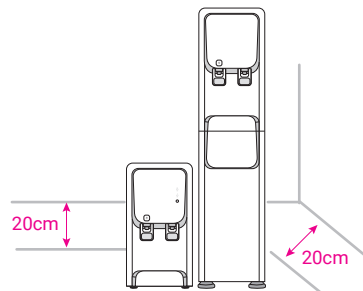

3. Precautions to ensure safe usage

7. Avoid exposure to heat and the direct sun-light.

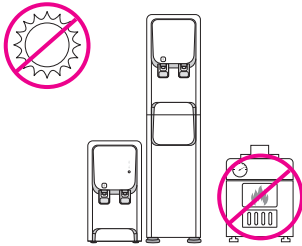

8. Set the product on hard and level surface.

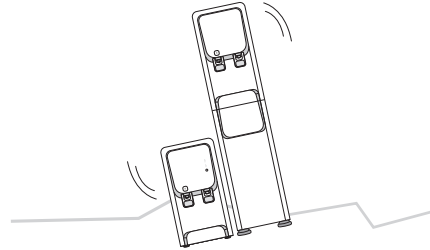

9. Connect only to the cold water pipe of tap.

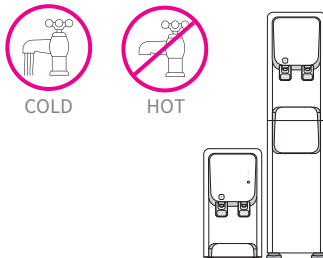

10. Product should be installed in a room-temperature between 4°C and 45°C. If not, it makes filter life shorter.

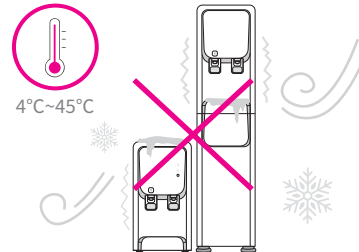

11. Do not use alcohol or aerosol, wax, benzene to prevent the deformability.

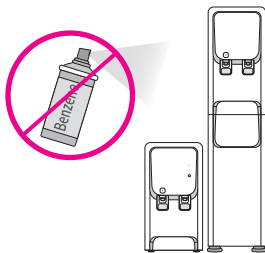

12. Do not disassemble the unit yourself, when it is found to be defective. Please call the service-center.

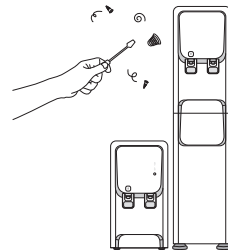

3. Precautions to ensure safe usage

13. Do not place objects on the top of the unit. It may cause damage.

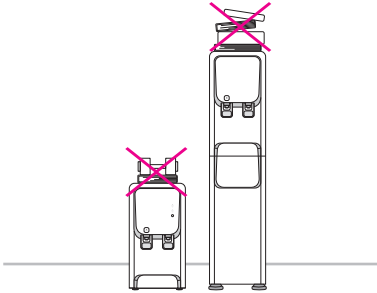

14. Do not move the unit while in operation.

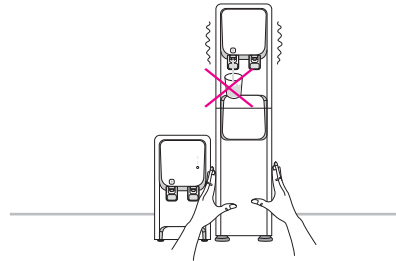

- When disposing waste from the appliance and/or water-filters, please dispose by following specified processing procedures.
 - If not, it will cause pollution.
- Replace parts by using only genuine parts purchased from reliable source. (water-hoses, top water-valves, water-filters. Etc.)
 - If not, it may cause leaks and damages to the product.
- Replace the filter by using only genuine filter purchased from reliable source.
 - If not, it may cause low-quality and odd taste of water
- Do not install in places where there is a risk of frost-accident during winter.



Before use, entirely close the cold tank cover in the unit.

- Insects or foreign substances may get inside of the product.

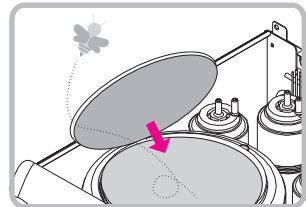

4. Characteristics

■ Convenient home water purifier

Based on 4 people, capacity of 10L / 1 day can be used more conveniently at home.

■ Water supply system is directly connected to home water-source plumbing.

Water is supplied with convenience and affordable price.

■ Thorough purification system

1st Step. Sediment Filter (removes contaminants)

2nd Step. Pre-carbon Filter (removes residual chlorine)

3rd Step. U/F Filter, R/O membrane Filter (removes bacteria and harmful organic chemicals)

4th step. Post-carbon Filter / Alkali Filter (removes residual toxic gas composition and odor)

■ The safety-function of hot water operation

By overheating-protection heater (bimetal manual return) and automatic temperature control (bimetal automatic return), it is easy to use.

■ Automatic water level adjustment

Because the water level is automatically adjusted, filter life is increased as well as product durability.

■ Fresh drinking water supply

Cold-water (4°C ~ 12°C) and hot-water (70°C ~ 90°C) can be used anytime. And by preventing from external dust and bacterial contamination, gives fresher water supply.

■ Modern design

The sensory, modern and elegant design fits everywhere and stands out.

■ Power-saving features

If you use only cold water turn off the hot water switch. You can reduce the electric rates of household by saving electricity cost.

■ Economic / practical advantages

Easy to install and easy to use.

5. Installation method

1. Do not exert excessive power when unpacking.

2. Remove tapes attached at the time of shipping to secure parts.

3. Do not tilt the product more than 45 degrees while moving the product.

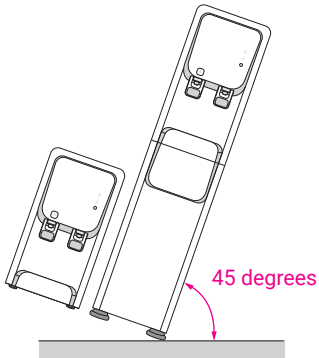

4. Place the product on a flat-surface, horizontal and structurally sound floor.

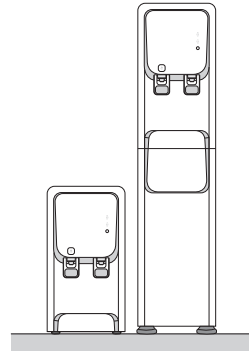

5. Close the main feed-water valve before installation.

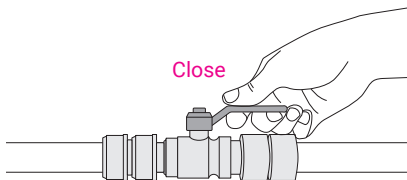

6. Open the tap for connecting and remove the remaining water in piping-system.

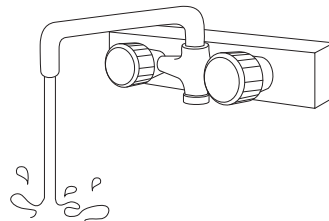

5. Installation method

7. Detach the faucet from the water pipe and connect the main water adaptor to the water pipe.

※ Connect the adaptor to the cold water pipe only.

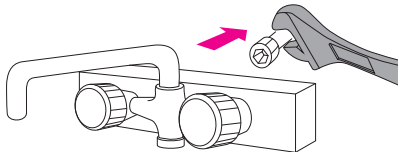

8. Connect the inlet tube to the adaptor.

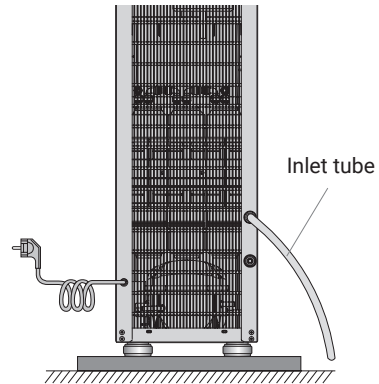

9. Do not use product for at least one hour after the product is moved to another place.

1 hour more

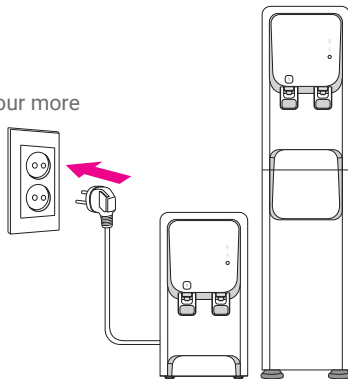

10. Do not supply electric power before filling with water in hot water tank and cold water tank.

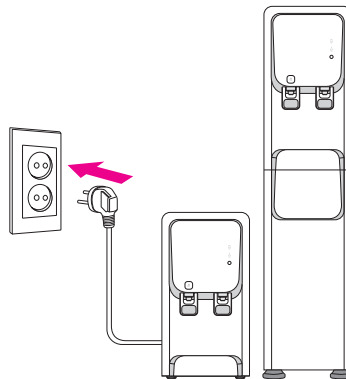

6. How to turn power on and get intake water

1. When the first time you turn on the power.
If you plug the power outlet, the lamp will light on.

2. Setting up hot water function.

■ How to set up function

- 1) Turn on the hot water switch on the rear of the product.
- 2) "Hot" lamp will light "ON", after the cold water switch is turned on.
- 3) After the hot water switch is turned on, about 20 minutes later, hot water intake is possible. (At first)
- 4) After setting hot water function, temperature control device automatically control hot water temperature.

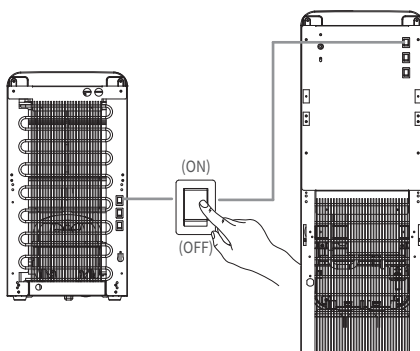

Caution

Before turn hot water switch on, make sure that water comes out from hot water tap

- It may cause malfunction.

3. How to get hot water intake.

Press the hot safety button then press the hot water faucet.
While the faucet is being pressed, hot water comes out.

- Please press the cup in the direction of the arrow.
- After you install the product, dump the purified over 20L water and then use the clean water.
- If you didn't use water purifier for a long time, dump the purified water 1~2L water and then use the clean water.

■ How to stop hot water intake

During hot water comes out, release the hot water faucet. Hot water will stop.

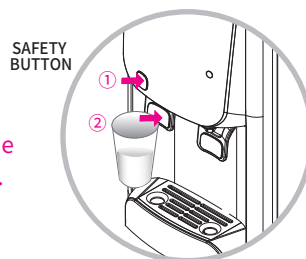

6. How to turn power on and get intake water

4. Setting up cold water function. (Cold water switch option)

■ How to operate

- 1) Turn on the cold water switch on the rear of the product.
- 2) "Cold-water/ lockout" lamp will light "ON", after the switch is turned on.
- 3) 90 minutes later after Cold-water switch is turned on, Cold-water intake is possible.
- 4) During Cold-water operation, temperature control device will automatically control Cold-water temperature.

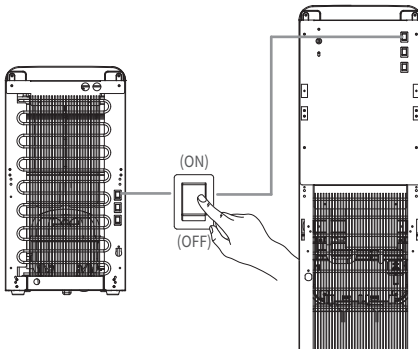
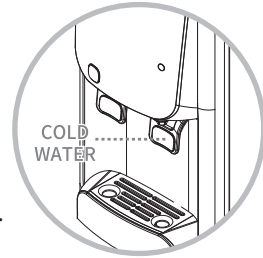

⚠ Caution

Before turn cold water switch on, make sure that water comes out from cold water tap.

- It may cause malfunction.

7. Maintenance

- Always unplug the power cord before cleaning the product.
 - Never use detergent or chemicals.
 - Wipe the front and back of the product with water-soaked, soft cloth.
 - Do not directly spray water on the surface of the product.
 - If dust or other foreign substance has accumulated on the condenser, wipe off with water-soaked soft cloth.
 - After cleaning the product, completely dry it before applying electric power.

- If the product won't be used for a prolonged period.
 - Water can be drained completely by loosening the Hot and Cold water caps.
 - Wipe dry any remaining surface moisture from each part of the product.
Damp surface will create rust.
 - Wrap the product in its original plastic bag and corrugated paper used for Shipping, before storage, to prevent from being damaged by rust, dust and other foreign substances.
 - Unplug the power cord.

8. ECO SYSTEM

WHP-1800 / WHP-1800S U/F type

- ECO function helps save power consumption by sensing illuminance around the unit. When the illuminance around the unit darkens at night, the product automatically stops water heating. When the illuminance around the unit brightens again, the sensor automatically stops ECO function and the product works normally.

- ① Turn on the ECO switch at the back side of unit.
- ② And you can check that the amber light comes on in the HOT water lamp.
- ③ When activated, the green light comes on in the HOT water lamp.

ECO SW ON (Day) -HOT water lamp : Amber

ECO SW ON (Night) -HOT water lamp : Green

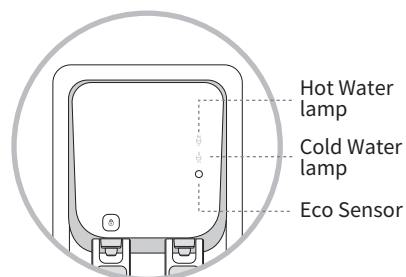

WHP-1800 / WHP-1800S R/O type

- ECO function helps save power consumption by sensing illuminance around the unit. When the illuminance around the unit darkens at night, the product automatically stops water heating & chilling. When the illuminance around the unit brightens again, the sensor automatically stops ECO function and the product works normally.

- ① Turn on the ECO switch at the back side of unit.
- ② And you can check that the amber light comes on in the HOT water lamp.
- ③ When activated, the green light comes on in the HOT water lamp and HOT & COLD water lamps flicker.

(When activated during turning off a switch of HOT or COLD, the lamp switched off does not flicker.)

• ECO S/W ON (Day) – HOT water lamp : Amber

• ECO SW ON (Night) - HOT & COLD water lamp : Green and Blue Flickering

9. Filter Exchanging Method

■ When replacing filter, unplug the power-cord and close the main feed-water valve.

1. Detach the waste water tank from the product.

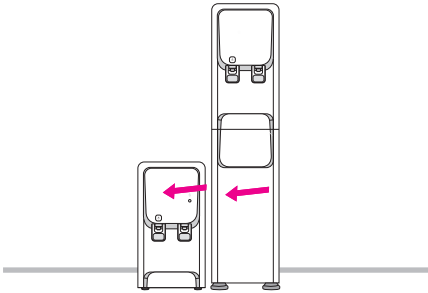

2. Detach the front lower cover by pulling down it.

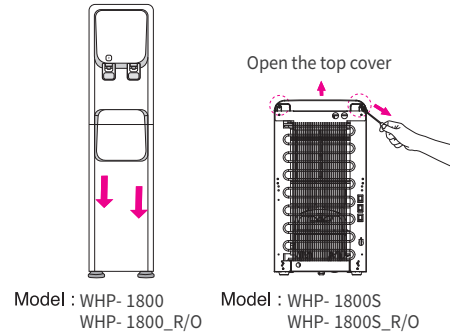

3. After replacing filter, re-assemble back the front cover and screw.
(After feed-water is turned on, check any leakage of water.)

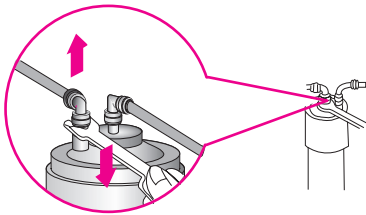

4. Open the main water adaptor and insert the electric power plug.

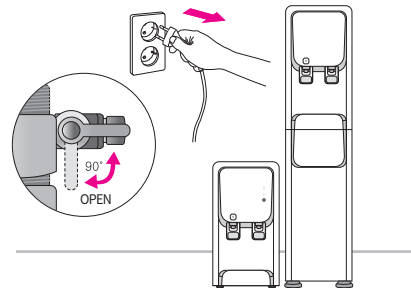

■ Precaution

- Replace filters according to the filter exchanging period.
- Purifying effect, water quantity and quality goes down - if filters are used longer than recommended period.
- Contact service center for filter order and exchange.
Sediment filter : Abt. 4months, Pre-Carbon filter : Abt. 8months
U/F Membrane filter : Abt. 20months, R/O Membrane filter : Abt. 24 months
Post-Carbon filter : Abt. 12 months
- * Life of filter depends upon the water quantity and quality

10. Cleaning Method

1. Close the main feed-water valve and drain water from the dispensing faucet of the product.

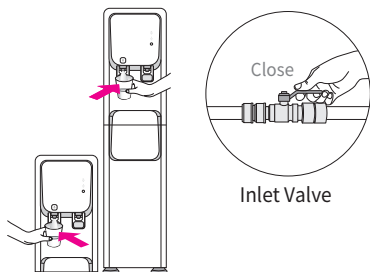

2. Unplug the power.

3. Open the drain valve (hot water) and drain remaining water completely. Be careful when using drain valve(hot).
• It may cause burns.

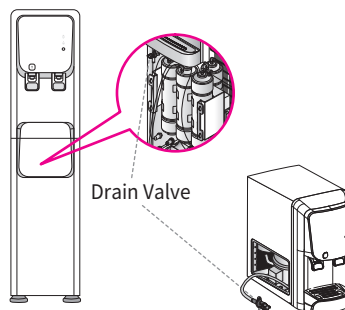

Drain valve of WHP-1800(WHP-1800_R/O) is placed inside the lower front panel on the left of the product.

4. Remove the left and right screws on rear side of product and remove the top cover.

5. Open the lid of cold water tank in the inside of product.

Caution : Be careful not to damage the silicone packing.

6. After washing with water, close the drain valve and then put the lid on the cold water tank.

Caution : In the case of self-cleaning. Be careful the electric shock and we shall not be liable to the damage.

Part to be cleaned	Frequency	Cleaning Method						
Waste Water Tank	Twice daily	Check frequently, and wipe off with neutral detergent.						
Hot/Cold Water Faucet	Once Daily	Clean with damp cloth, and then wipe, using dry cloth.						
Exterior	Once per 3 days	Clean with damp cloth. Do not use gasoline, benzene, etc. as such materials may change the surface color or scratch the surface.						
Filter	On the period of use	<table border="0"> <tr> <td>Sediment filter : Abt. 4 months</td> <td>Pre-carbon filter : Abt. 8 months</td> </tr> <tr> <td>U/F Membrane filter : Abt. 20 months</td> <td>R/O Membrane filter : Abt. 24 months</td> </tr> <tr> <td>Post-carbon filter : Abt. 12 months</td> <td>Alkali filter : Abt. 12 months</td> </tr> </table>	Sediment filter : Abt. 4 months	Pre-carbon filter : Abt. 8 months	U/F Membrane filter : Abt. 20 months	R/O Membrane filter : Abt. 24 months	Post-carbon filter : Abt. 12 months	Alkali filter : Abt. 12 months
Sediment filter : Abt. 4 months	Pre-carbon filter : Abt. 8 months							
U/F Membrane filter : Abt. 20 months	R/O Membrane filter : Abt. 24 months							
Post-carbon filter : Abt. 12 months	Alkali filter : Abt. 12 months							

11. Product specifications

Product Name	Cold/Hot Water Purifier	
Model No.	WHP-1800S(R/O)	WHP-1800(R/O)
External Dimensions(mm)	260(L) x 485(W) x 495	260(L) x 365(W) x 1100
Weight	Abt. 17Kg (19kg)	Abt. 21Kg (24kg)
Rated Power	AC 220 - 240V / 50Hz	
Compressor	1/11 HP Sealed Type	
Condenser	Wire Type	
Motor Power Consumption	0.7A / 90W	
Refrigerant	R-134a	
Cold Water Tank	STS 304, About 3 Liters	
Cold Water Capacity	About 20 Cups at 4~12°C	
Temperature Control	Thermostat(in Cold)	
Cooling	Forced Cooling Type	
Heater Power Consumption	400-470W or 430-510W	
Hot Water Tank	STS 304, Abt. 1.4 Liters	STS 304, Abt. 1.8 Liters
Hot water capacity	About 10 cups at 70~90°C	
Heater	SHEATH or BAND Type	
Temperature Control (In HOT)	Bi-metal	
Overheat Protection Device	Bi-metal	
Power Cord Length	2m	
Front Cover	ABS	
Side Panel	EGI	
Faucet	ABS	
Purification Type	U/F(R/O) type	
Filtration system	Sediment filter, Pre-carbon filter U/F filter (R/O filter), Post-Carbon filter (Alkali filter)	

12. In Case of something wrong

State	Cause	Countermeasure
Do not work and cooling	<ol style="list-style-type: none"> 1. Electric cord is wrong. 2. Power cord is bed. 3. Fuse is cut. 	<ul style="list-style-type: none"> • Check the electric power of the machine and make sure it complies with your electric power. • Replace a good quality cord. • Change with a new fuse.
It is not good in cooling	<ol style="list-style-type: none"> 1. Airing of the back side is bad. 2. Temperature of supplied water is so bad. 3. The place of the thermostat controller is not good. 	<ul style="list-style-type: none"> • Maintain at least 20cm from wall for a good ventilating. • Temperature of supplied water should be below 30°C. • Move the thermostat controller to more colder place.
Noise and strange sound	<ol style="list-style-type: none"> 1. Product is not installed on a flat, level surface. 2. Touching the products. 	<ul style="list-style-type: none"> • Place unit on hard level floor. • Confirm the touching with any other product and remove the obstacles.
Hot water not working well	<ol style="list-style-type: none"> 1. Electric power is not inserted. 2. Water level is low. 	<ul style="list-style-type: none"> • Check electric power cord is on. • Supply water and fill the storage tank.
A leakage of water	<ol style="list-style-type: none"> 1. Connecting tube is loose. 	<ul style="list-style-type: none"> • Confirm the connecting tube and connect the loose tubes firmly.
Clean water is slowly produced	<ol style="list-style-type: none"> 1. Connecting tube is loose. 2. It is time to change filter. 	<ul style="list-style-type: none"> • Check water leakage. • Change filter.
The bad taste of water	<ol style="list-style-type: none"> 1. Life of post-carbon(Alkali) filter expired. 2. Cold tank is not cleaned. 3. Water has been stored in an inappropriate condition for a prolonged period. 	<ul style="list-style-type: none"> • Replace post-carbon (Alkali) filter. • Clean cold tank. • Replace all the filters and clean cold tank.
Particle like a piece of ice be produced	<ol style="list-style-type: none"> 1. Thermostat badly controlled. 	<ul style="list-style-type: none"> • Adjust the thermostat control to proper position.
Water is filled with the storage tank quicker than usual	<ol style="list-style-type: none"> 1. Life of R/O filter expired. 	<ul style="list-style-type: none"> • Drain water from storage tank and replace R/O filter.
Water is filled with the storage tank slower than usual (over 3 hours)	<ol style="list-style-type: none"> 1. Life of R/O filter expired. 2. Dust or other foreign substances accumulated on R/O filter remain unextracted. 	<ul style="list-style-type: none"> • Replace R/O filter

Warranty

Product Warranty Card

This product has passed the strict quality control and inspection processes of technicians, passed the inspection by the international Conformity Certification Program.

If the product is found to be defective, or goes out of order during normal usage within the warranty period, it will be repaired, and/or defective parts replaced, free of charge.

WARRANTY GUIDE

1. The warranty period is 12 months from the date of purchase.
2. In the following cases, the product will be repaired at cost.
 - a) After expiry of free warranty period.
 - b) Malfunction caused by careless or abnormal use.
 - c) Malfunction caused by natural disaster.
 - d) Warranty card has been lost.

Product	Model	WHP-1800	
		WHP-1800_R/O	
		WHP-1800S	
		WHP-1800S_R/O	
	Type approval No.		
Manufacturing Date			
Purchase Date	Year	Month	Day
Purchaser Name			
Dealer			