

**We cannot take any responsibility
for any damage caused by not using
our genuine filter or part.**

HOT & COLD WATER PURIFIER OPERATION MANUAL

To keep the best working condition and guarantee long life,
read this manual carefully before you operate this equipment.

EPU-030C
EPU-030S
EPU-030S_R/O

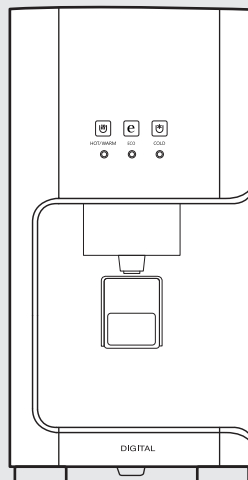
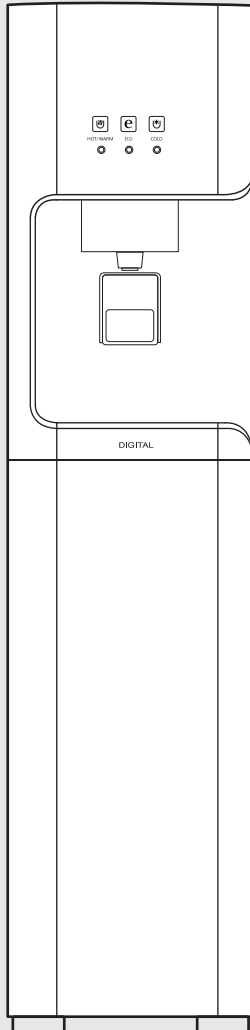

1. Name of each part (Exterior)

Model No / EPU-030C

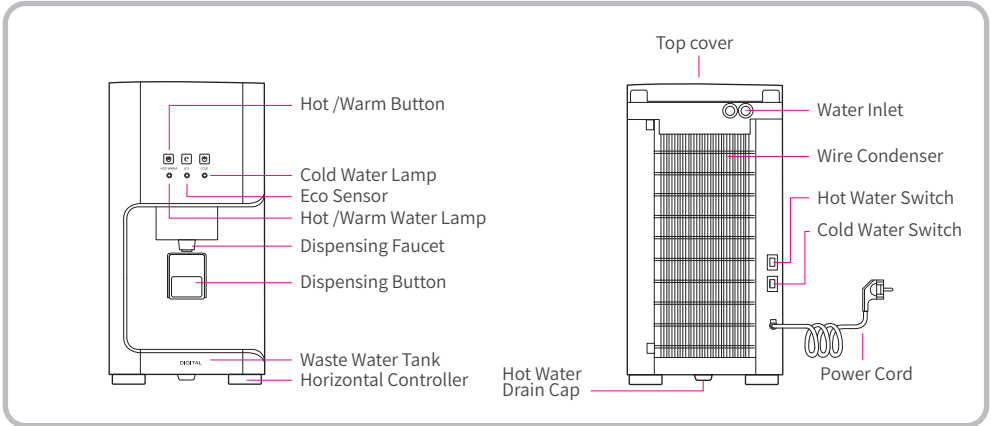

Model No / EPU-030S, EPU-030S_RO

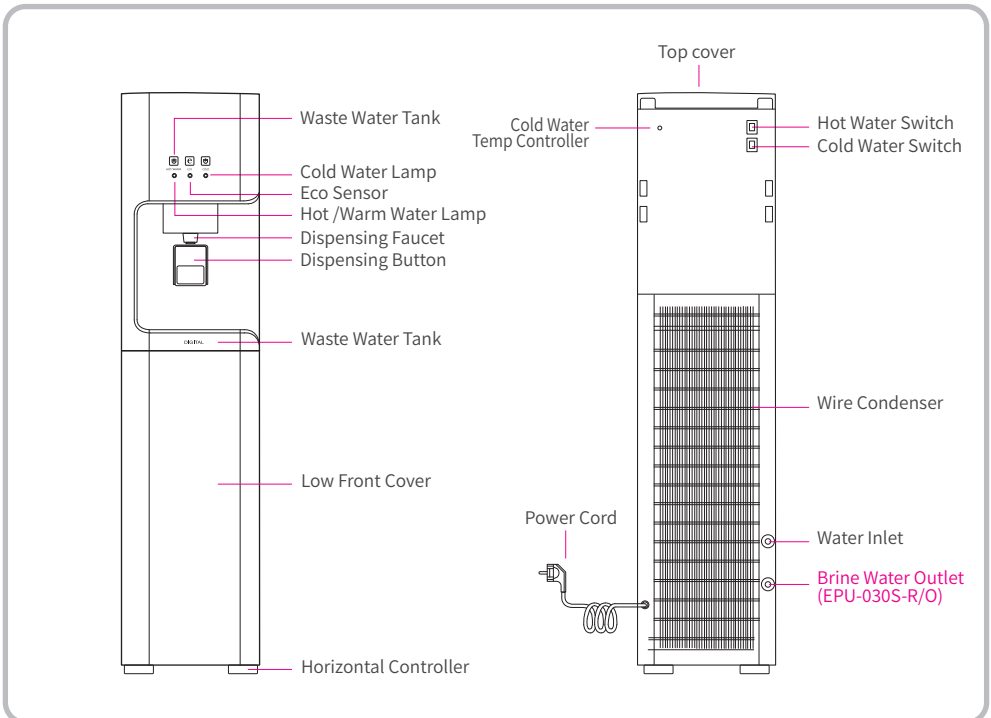

2. Interior Structure

U/F Filtration system

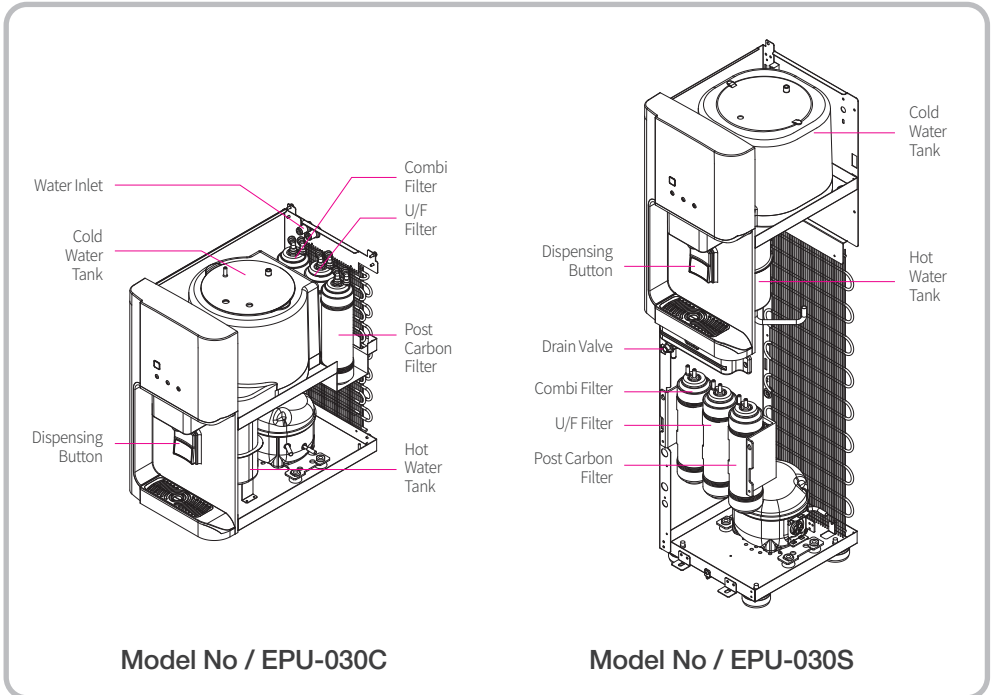

U/F Purifying system

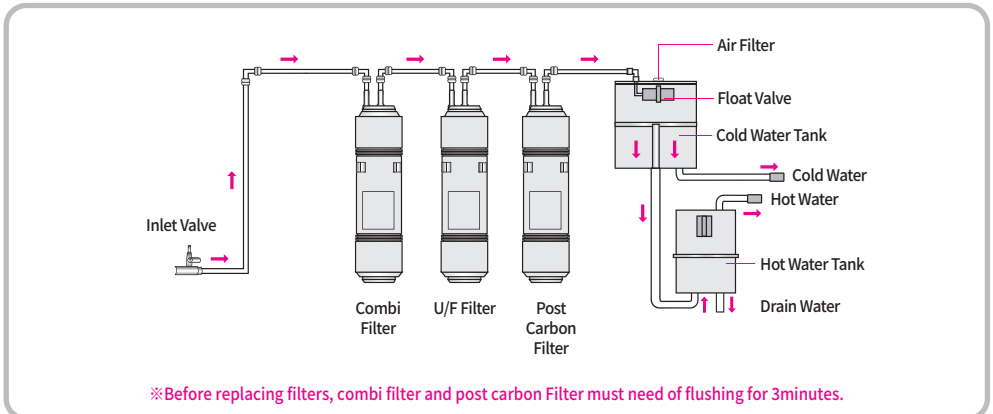

2. Interior Structure

R/O Filtration System

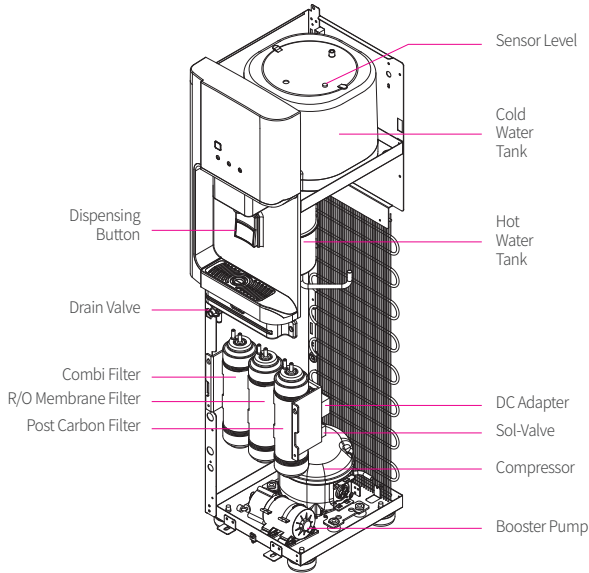

Model No / EPU-030S_R/O

R/O Purifying System

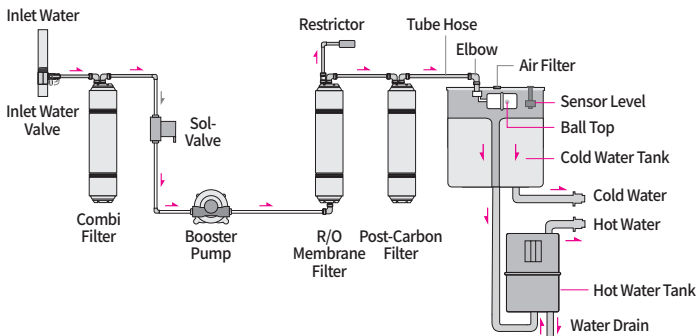

※ Before replacing filters, combi filter and post carbon Filter must need of flushing for 3minutes.

3. Precautions to ensure safe usage

1. Do not insert a plug in a loose wall outlet.

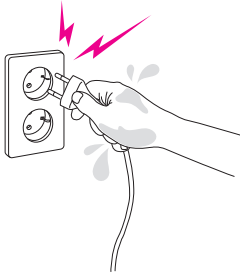

2. Check the electric power. Do not use except rated voltage.

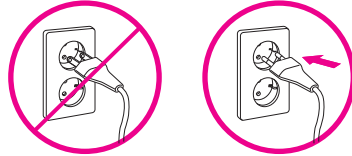

- If not, it may cause electric shock or fire

3. Do not plug in with other electrical appliance. The plug should be rated for more than 10A.

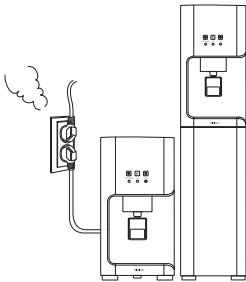

4. When unplugging the power cord, do not pull on the cord itself but pull on the plug.

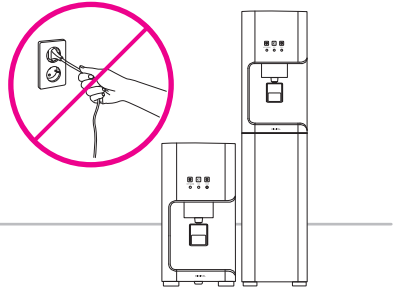

5. Do not expose the unit to moisture rain, or dust. Do not place it at outdoor or bathroom.

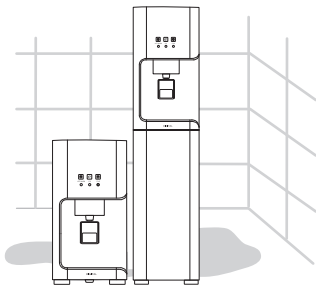

6. Maintain sufficient distance from wall, at least 20cm.

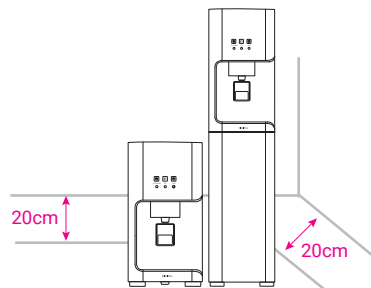

3. Precautions to ensure safe usage

7. Avoid exposure to heat and the direct sun-light.

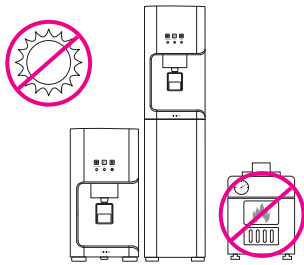

8. Set the product on hard and level surface.

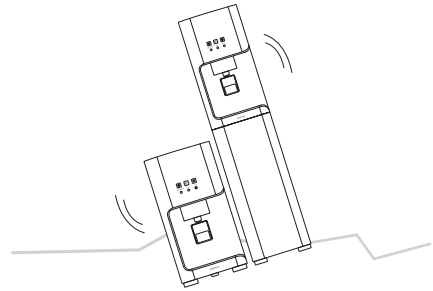

9. Connect only to the cold water pipe of tap.

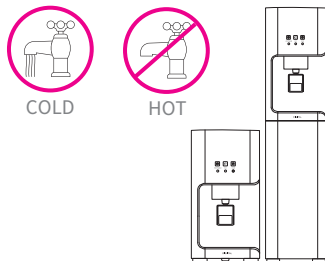

10. Product should be installed in a room-temperature between 4°C and 45°C. If not, it makes filter life shorter and winter-sowing.

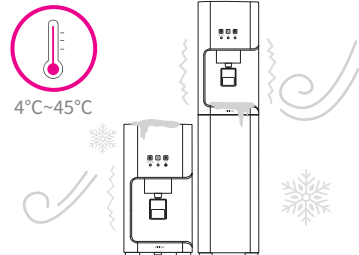

11. Do not use alcohol or aerosol, wax, benzene to prevent the deformability.

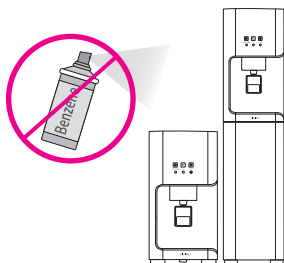

12. Do not take the unit to pieces when it is found to be defective. Please call the service-center.

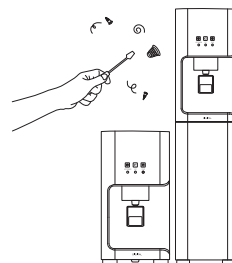

3. Precautions to ensure safe usage

13. Do not place objects on the top of the unit.
It may cause damage.

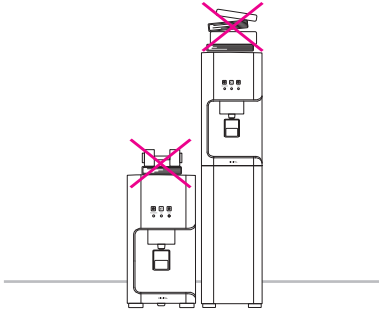

14. Do not move the unit while in operation.

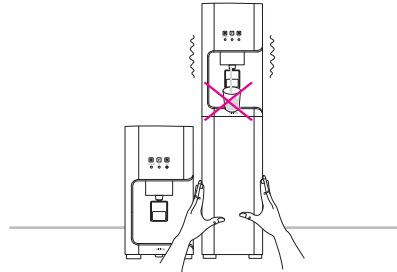

- When disposing waste home appliances and water filters, please dispose by the specified processing procedures.
 - If not, it will cause pollution.
- Install the product with using genuine parts of our company. (water-hoses, tap water-valves, water-filters, etc.)
 - If not, it will cause leaks and damages of product.
- Replace the filter by using only genuine filter purchased from reliable source.
 - If not, it may cause low-quality and odd taste of water.
- In the place where there is a risk of frost accident in winter, do not install.

4. Characteristics

■ Convenient home water purifier

Based on 4 people, capacity of 10 L / 1 day can be used more conveniently at home.

■ Water supply system is directly connected to home water-source plumbing.

Water is supplied with convenience and affordable price.

■ Thorough purification system

1st Step. Combi Filter (removes contaminants and residual chlorine)

2nd Step. U/F hollow fiber membrane Filter or R/O membrane Filter
(removes bacteria and harmful organic chemicals)

3rd Step. Post-carbon Filter (removes Residual toxic gas composition and odor)

■ The safety-function of hot water operation

By overheating-protection heater (bimetal manual return) and automatic temperature control (bimetal automatic return), it is easy to use.

■ Automatic water level adjustment

Because the water level is automatically adjusted, filter life is increased as well as product durability.

■ Fresh drinking water supply

Cold-water (4°C ~ 12°C) and hot-water (70°C ~ 90°C) can be used anytime. And by preventing from external dust and bacterial contamination, gives fresher water supply.

■ Modern design

The sensory, modern and elegant design fits everywhere and stands out.

■ Power-saving features

If you use only cold water, Turn off the hot water switch. You can reduce the electric rates of household by saving electricity cost.

■ Economic / practical advantages

Easy to install and easy to use.

5. Installation method

1. Do not exert excessive power when unpacking.

2. Remove tapes attached at the time of shipping to secure parts.

3. Do not tilt the product more than 45 degrees while moving the product.

4. Place the product on a flat-surface, horizontal and structurally sound floor.

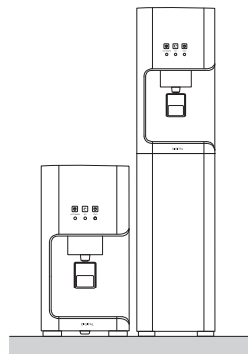
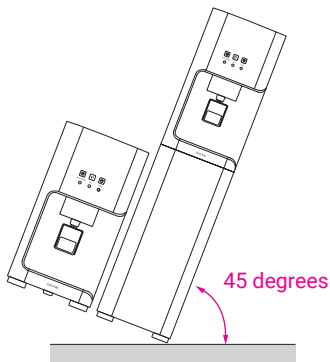

5. Close the main feed-water valve before installation.

6. Open the tap for connecting and remove the remaining water in piping-system.

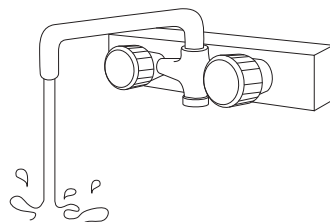
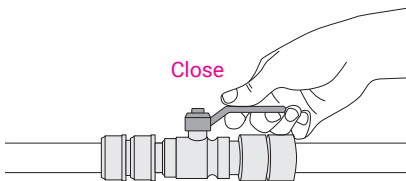

5. Installation method

7. Detach the faucet from the water pipe and connect the main water adaptor to the water pipe.

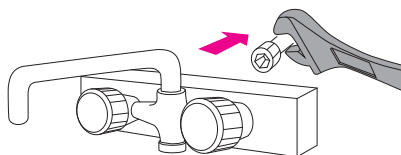

8. Connect the inlet tube to the adaptor.

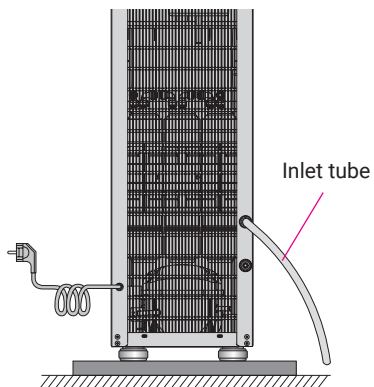

9. Do not use product for at least one hour after the product is moved to another place.

1 hour more

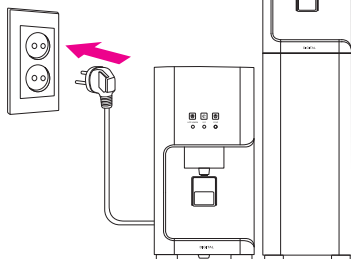

10. Do not supply electric power before filling with water in hot water tank and cold water tank.

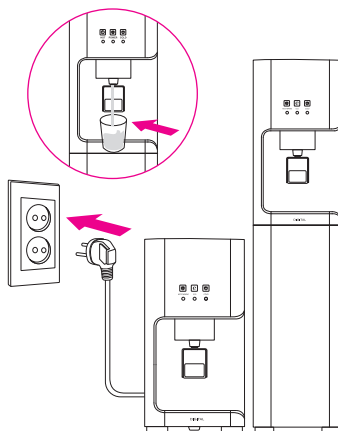

6. How to turn power on and get intake water

1. Setting up hot water function and how to intake water.

■ How to set up function

- 1) Plug the power outlet and turn on the hot water switch on the rear of the product.
- 2) If the switch is turned on, HOT/WARM water lamp is "ON".
- 3) After the hot water switch is turned on, about 20 minutes later, hot water intake is possible. (At first.)
- 4) After setting hot water function, temperature control device automatically control hot water temperature.

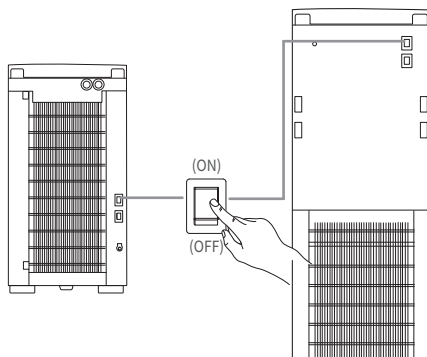

⚠ NOTICE

After confirming that the water coming from hot water tank, you must turn on the hot water switch. (When the water comes out from the hot water faucet, turn on the hot water switch of the rear).

- It may cause malfunction.

2. Setting up hot water function and how to intake water.

■ How to set up function

- 1) Turn on the cold water switch on the rear of the product.
- 2) If the switch is turn on, HOT/WARM water lamp is "ON".
- 3) After the cold water switch is turned on, about 1 hour later water intake is possible. (At first.)

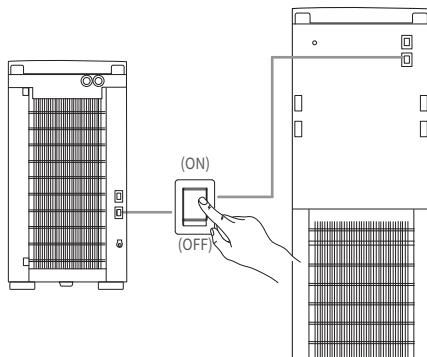

⚠ NOTICE

If you press the HOT/WARM button during cold water comes out, it will turn into hot water.

6. How to turn power on and get intake water

■ TYPES OF WATER TEMPERATURE AVAILABLE

- How to get Cold water :
Just push the Dispensing button.
(While dispensing, The Cold Water Lamp will be on.)
- How to get Hot water :
Press HOT/WARM button once,
then push the Dispensing button.
(While dispensing, the HOT/WARM Water Lamp will be on.)
- How to get Warm water :
Press HOT/WARM button twice,
then push the Dispensing button
within 3 seconds.
(While dispensing, The Cold Water Lamp will be on.)

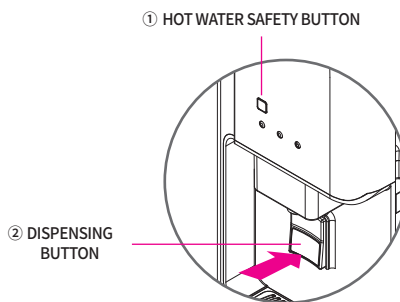

- Please press the cup in the direction of the arrow.
- After you install the product, dump the purified over 10L water and then use the clean water.
- If you didn't use water purifier for a long time, dump the purified water 1~2L water and then use the clean water.

■ ECO SYSTEM (ENERGY SAVING FUNCTION)

- Automatically power off the heating system at night by the photo detector.
- To turn off the ECO system, press the HOT/WARM button for about 5 seconds.
- If energy saving function is turned on, the degree of brightness of the HOT/WARM water LED and COLD water LED become dark.
- After the energy saving function is activated, when the light sensor detects darkness, the HOT/WARM water LED blinks.

7. Maintenance

- Always unplug the power cord before cleaning the product.
 - Never use detergent or chemicals.
 - Wipe the front and back of the product with water-soaked, soft cloth.
 - Do not directly spray water on the surface of the product.
 - If dust or other foreign substance has accumulated on the condenser, wipe off with water-soaked soft cloth.
 - After cleaning the product, completely dry it before applying electric power.
- If the product won't be used for a prolonged period.
 - Water can be drained completely by loosening the Hot and Cold water caps.
 - Wipe dry any remaining surface moisture from each part of the product.
Damp surface will create rust.
 - Wrap the product in its original plastic bag and corrugated paper used for shipping, before storage, to prevent from being damaged by rust, dust and other foreign substances.
 - Unplug the power cord.

8. Filter Exchanging Method

■ In case of exchanging filter, take out the electric plug and close the main valve.

1. Detach the waste water tank from the product.

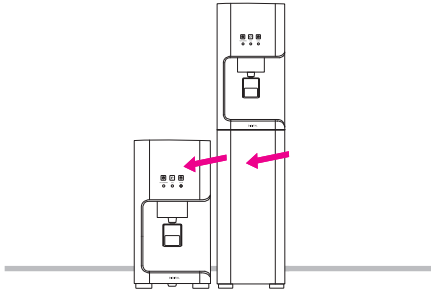

2. Detach the front lower cover by pulling down it.

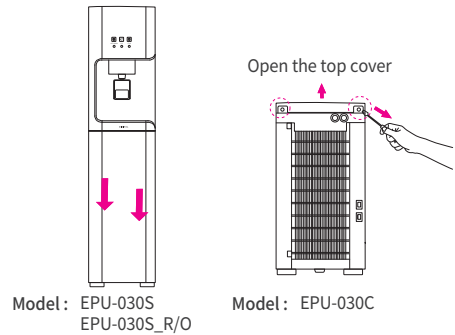

3. After exchanging the filter, assemble front cover and screw by reverse.
(After main water are supplied, check the leakage of water)

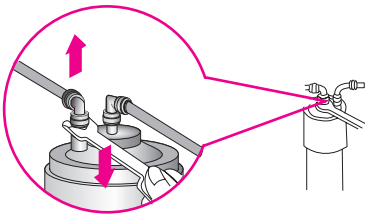

4. Open the main water adaptor and insert the electric power plug.

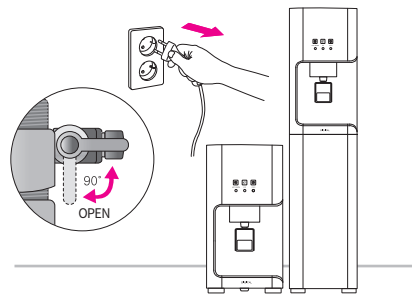

■ Precaution

- Exchange the filters according to the filter exchanging period.
- Using filter longer than recommended period, purifying effect and water quantity and quality goes down.
- Contact service center for filter order and exchange.
Combi filter : Abt. 4months
U/F filter : Abt. 20months
R/O filter : Abt. 24 months
Post Carbon filter : Abt. 12 months
- * Life of filter depends upon the water quantity and quality

9. Cleaning Method

1. Close the main feed-water valve and drain water from the dispensing faucet of the product.

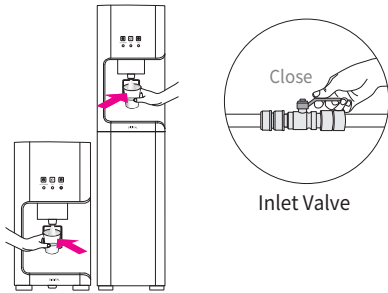

2. Unplug the power.

3. Open the drain valve (hot water) and drain remaining water completely. Be careful when using drain valve(hot).
 - This may cause burns.

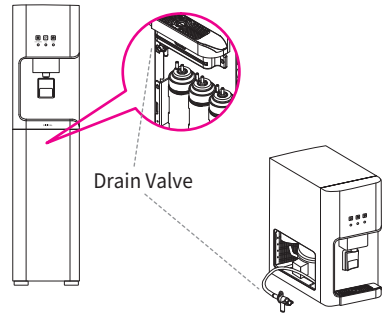

Drain valve of EPU-030C is placed inside the lower front panel on the left of the product.

4. Remove the left and right screws on rear side of product and remove the top cover.
5. Open the lid of cold water tank in the inside of product.

⚠ Caution : Be careful not to damage the silicone packing.

6. After washing with water, close the drain valve and then put the lid on the cold water tank.

⚠ Caution : In the case of self-cleaning. Be careful the electric shock and we shall not be liable to the damage.

Part to be cleaned	Frequency	Cleaning Method
Waste Water Tank	Twice daily	Check frequently, and wipe off with neutral detergent.
Hot/Cold Water Faucet	Once Daily	Clean with damp cloth, and then wipe, using dry cloth.
Exterior	Once per 3 days	Clean with damp cloth. Do not use gasoline, benzene, etc. as such materials may change the surface color or scratch the surface.
Filter	On the period of use	Combi filter : Abt. 4 months U/F filter : Abt. 12 months, R/O Membrane filter : Abt. 24 months Post-carbon filter : Abt. 9~12 months

11. Product specifications

Product Name	Cold/Hot Water Purifier		
Model No.	EPU-030C	EPU-030S	EPU-030S_R/O
External Dimensions(mm)	260x459x496	260x347x1100	260x347x1100
Weight	Abt. 27Kg	Abt. 28Kg	Abt. 31Kg
Rated Power	AC 220 - 240V / 50Hz or AC 120V / 60Hz		
Compressor	1/11 HP Sealed Type		
Condenser	Wire Type		
Motor Power Consumption	0.7A / 90W		
Refrigerant	R-134a		
Cold Water Tank	STS 304, About 3 Liters		
Cold Water Capacity	About 20 Cups at 4~12°C		
Temperature Control	Thermostat(in Cold)		
Cooling	Forced Cooling Type		
Heater Power Consumption	300-360W	430-510W or 480W(AC 120V)	
Hot Water Tank	STS 304, Abt. 1.4 Liters	STS 304, Abt. 1.8 Liters	
Hot water capacity	About 10 cups at 70~90°C		
Heater	SHEATH Heater	BAND Heater	
Temperature Control (In HOT)	Bi-metal		
Overheat Protection Device	Bi-metal		
Power Cord Length	2m		
Front Cover	ABS		
Side Panel	EGI		
Faucet	ABS Assembly		
Purification Type	U/F Type		R/O Type
Filtration system	Combi Filter U/F Filter Post-Carbon Filter		Combi Filter R/O Filter Post-Carbon Filter
	※ Other filtration system is available upon your request.		

11. In Case of something wrong

State	Cause	Countermeasure
Do not work and cooling	<ol style="list-style-type: none"> 1. Electric power is wrong. 2. Power cord is bad. 3. Fuse is cut. 	<ul style="list-style-type: none"> • Check the electric power of the machine and make sure it complies with your electric power. • Replace a good quality cord. • Change with a new fuse.
It is not good in cooling	<ol style="list-style-type: none"> 1. Airing of the back side is bad. 2. Temperature of supplied water is so bad. 3. The place of the thermostat controller is not good. 	<ul style="list-style-type: none"> • Maintain at least 20cm from wall for a good ventilating. • Temperature of supplied water should be below 30°C. • Turn the thermostat controller to more colder place.
Noise and strange sound	<ol style="list-style-type: none"> 1. Product is not installed on a flat, level surface. 2. Touching the products. 	<ul style="list-style-type: none"> • Place unit on hard, level floor. • Confirm the touching with any other product and remove the obstacles.
Hot water not working well	<ol style="list-style-type: none"> 1. Electric power is not inserted. 2. Water level is low. 	<ul style="list-style-type: none"> • Check electric power cord is on. • Supply water and fill the storage tank.
A leakage of water	<ol style="list-style-type: none"> 1. Connecting tube is loose. 	<ul style="list-style-type: none"> • Confirm the connecting tube and connect the loose tubes firmly.
Clean water is slowly produced	<ol style="list-style-type: none"> 1. Connecting tube is loose. 2. It is time to change filter. 	<ul style="list-style-type: none"> • Check water leakage. • Change filter.
The bad taste of water	<ol style="list-style-type: none"> 1. Life of post-carbon filter expired. 2. Cold tank is not cleaned. 3. Water has been stored in an inappropriate condition for a prolonged period. 	<ul style="list-style-type: none"> • Replace post-carbon filter. • Clean cold tank. • Exchange all the filters and clean cold tank.
Particle like a piece of ice be produced	<ol style="list-style-type: none"> 1. Thermostat badly controlled. 	<ul style="list-style-type: none"> • Adjust the thermostat control to proper position.
Water is filled with the storage tank quicker than usual	<ol style="list-style-type: none"> 1. Life of R/O filter expired. 	<ul style="list-style-type: none"> • Drain water from storage tank and exchange U/F(R/O) filter.
Water is filled with the storage tank slower than usual (over 3 hours)	<ol style="list-style-type: none"> 1. Life of U/F(R/O) filter expired. 2. Dust or other foreign substances accumulated on U/F(R/O) filter remain unextracted. 	<ul style="list-style-type: none"> • Exchange U/F(R/O) filter.

MEMO

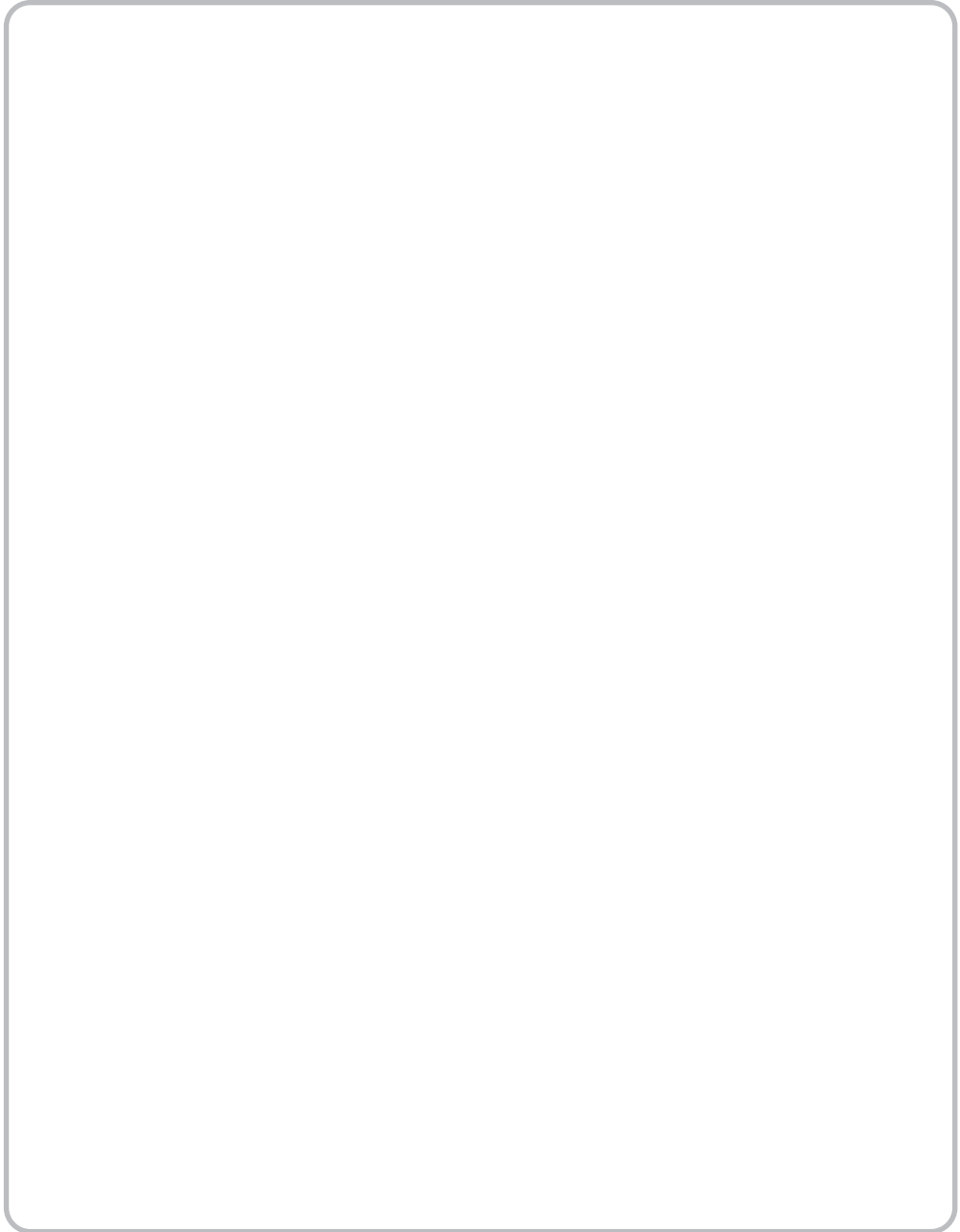

Warranty

Product Warranty Card

This product has passed the strict quality control and inspection processes of technicians, passed the inspection by the international Conformity Certification Program.

If the product is found to be defective, or goes out of order during normal usage within the warranty period, it will be repaired, and/or defective parts replaced, free of charge.

WARRANTY GUIDE

1. The warranty period is 12 months from the date of purchase.
2. In the following cases, the product will be repaired at cost.
 - a) After expiry of free warranty period.
 - b) Malfunction caused by careless or abnormal use.
 - c) Malfunction caused by natural disaster.
 - d) Warranty card has been lost.

Product	Model	EPU-030C	
		EPU-030S	
		EPU-030S_R/O	
	Type approval No.		
Manufacturing Date			
Purchase Date	Year	Month	Day
Purchaser Name			
Dealer			